

---

*APPENDIX G*  
*PARCEL 3 MILITARY MUNITIONS MAP*

---

REV. NO.	DATE	DESCRIPTION OF REVISION	REV. BY	ENG	CHKD BY	APPVD BY
1	11.20.07	SWMU/AOC UPDATE				

  

PROJECT MANAGER: E. KAMMERER	DRAWN BY: D. TAYLOR	DATE: 08.29.06
------------------------------	---------------------	----------------

<b>TerranearPMC</b> 222 VALLEY CREEK BLVD., SUITE 210 EXTON, PA 19341-2843 (610) 862-5000 PHONE (610) 862-5050 FAX			
<b>MILITARY MUNITIONS MAP</b> <b>OB/OD AREA</b>			
<b>Fort Wingate Depot Activity</b> <b>McKinley County, New Mexico</b>			
PROJECT NO.	FILE NO.	CHKD:	DRAWING NUMBER
33101		ENG:	20403
		APPVD:	0
		SCALE:	1" = 400'

- LEGEND**
- APPROXIMATE BOUNDARY OF GEOPHYSICAL ANOMALY/SURFACE DEBRIS/RESIDUE PILE
  - INTERPRETED SUBSURFACE RESIDUE/DEBRIS PILE AREA AFTER EXCAVATION
  - APPROXIMATE MEC LOCATION
  - APPROXIMATE EXTENT OF MEC CLEARANCE ACTIONS
  - EXTENT OF UXO SURVEY BOUNDARY CLOSED AND CURRENT OB/OD AREAS
  - EXPLOSIVE STAINED SOIL AREA
  - APPROXIMATE LOCATION OF FORMER OPEN DETONATION CRATER
  - APPROXIMATE LOCATION OF EXISTING OPEN DETONATION CRATER
  - APPROXIMATE BOUNDARY OF BURNING GROUND AREA
  - APPROXIMATE BOUNDARY OF OB/OD UNIT
  - 6-FOOT CHAIN LINK SECURITY FENCE WITH 3-STRAND BARBED WIRE TOP
  - 5-STRAND BARBED WIRE FENCE
  - SENSITIVE HABITAT (WETLAND)
  - SENSITIVE HABITAT (WILDLIFE)
  - WILLOW THICKET
  - COTTONWOOD GROVE
  - 100-YEAR FLOODPLAIN
  - ARROYOS
  - PROPERTY TRANSFER PARCEL BOUNDARIES
  - FWDA PROPERTY BOUNDARY, FEBRUARY 2002
  - SWMUs OR AOCs THAT REQUIRE CORRECTIVE ACTION

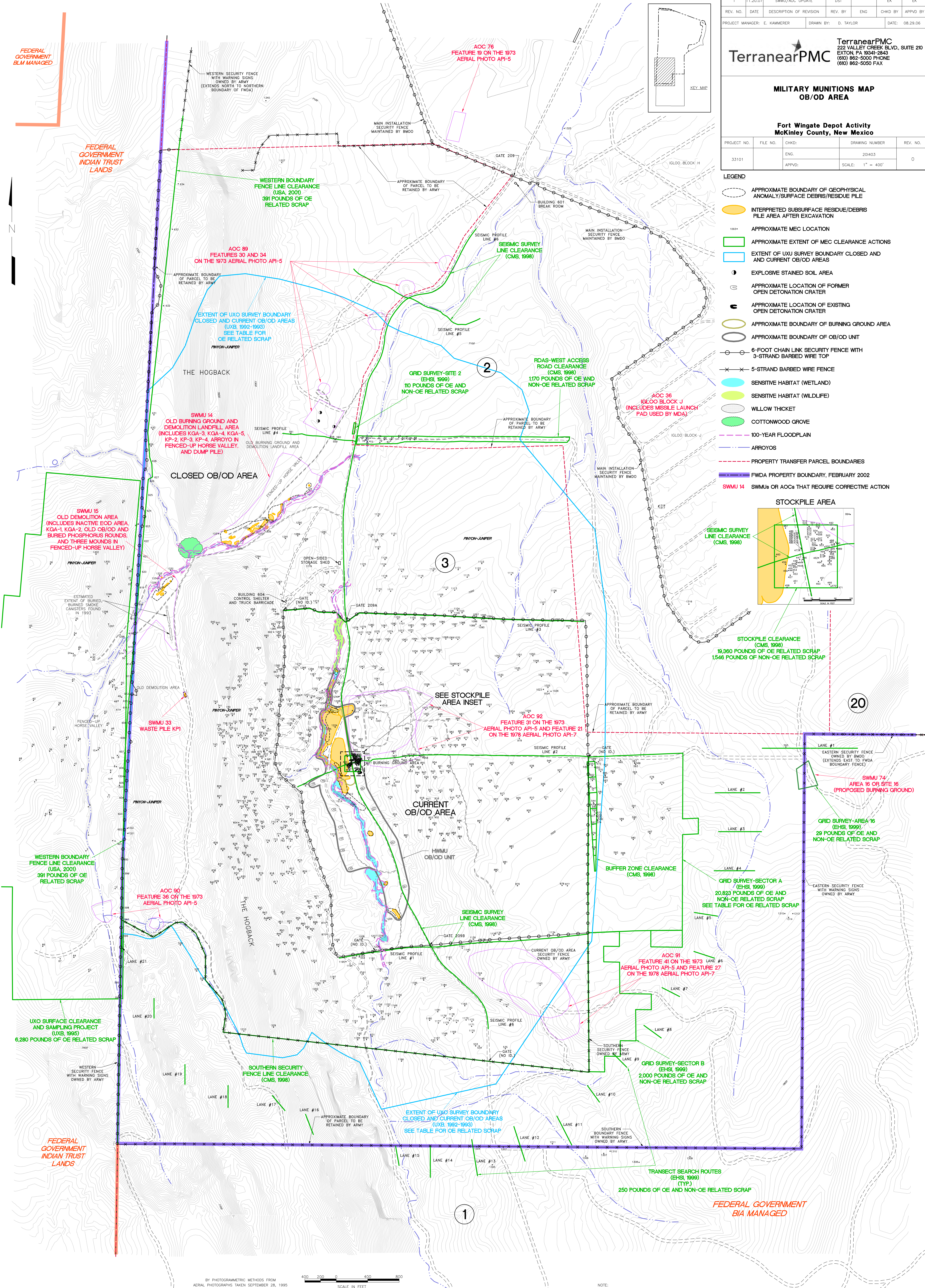
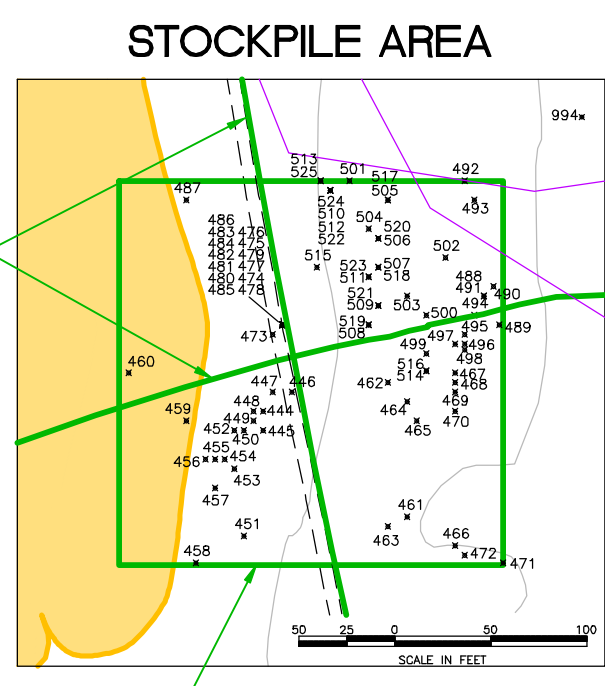

**Military Munitions Summary Table**  
**Parcel 3**  
**Fort Wingate Depot Activity**  
**Gallup, New Mexico**

Parcel No.	Removed	Item Description	Quantity	Depth (ft. BGS)	Mapped	Northing	Easting	Source	ID No.	Area Description
3	Yes	~2,000 lbs. of OE and NON-OE Related Scrap		0 - 4'	Yes			CMS-OE, 1998		Stockpile Clearance
3	Yes	0.2 pounds OE scrap (inert)		0 - 4'	Yes			CMS-OE, 1998		Stockpile Clearance
3	Yes	0.5 pounds OE scrap (inert)		0 - 4'	Yes			EHSI, 1999		Grid Survey - Sector A
3	Yes	0.5 pounds OE scrap (inert)		0 - 4'	Yes			EHSI, 1999		Grid Survey - Sector B
3	Yes	1 pounds OE scrap (inert)		0 - 4'	Yes			EHSI, 1999		Grid Survey - Site 2
3	Yes	1 pounds OE scrap (inert)	1	Surface	Yes	1614860.00	2488845.00	CMS-OE, 1998	444	Stockpile Clearance
3	Yes	1 pounds OE scrap (inert)	1	Surface	Yes	1614850.00	2488845.00	CMS-OE, 1998	445	Stockpile Clearance
3	Yes	1 pounds OE scrap (inert)	1	Surface	Yes	1614870.00	2488860.00	CMS-OE, 1998	446	Stockpile Clearance
3	Yes	1 pounds OE scrap (inert)	1	Surface	Yes	1614870.00	2488850.00	CMS-OE, 1998	447	Stockpile Clearance
3	Yes	1 pounds OE scrap (inert)	1	Surface	Yes	1614860.00	2488840.00	CMS-OE, 1998	448	Stockpile Clearance
3	Yes	1 pounds OE scrap (inert)	1	Surface	Yes	1614855.00	2488840.00	CMS-OE, 1998	449	Stockpile Clearance
3	Yes	1,546 lbs. of NON-OE Related Scrap	1	Surface	Yes	1614850.00	2488835.00	CMS-OE, 1998	450	Stockpile Clearance
3	Yes	10 pounds OE scrap (inert)	1	Surface	Yes	1614795.00	2488835.00	CMS-OE, 1998	451	Stockpile Clearance
3	Yes	10 pounds OE scrap (inert)	1	Surface	Yes	1614850.00	2488830.00	CMS-OE, 1998	452	Stockpile Clearance
3	Yes	110 lbs. of OE and NON-OE Related Scrap	1	Surface	Yes	1614830.00	2488830.00	CMS-OE, 1998	453	Stockpile Clearance
3	Yes	15 pounds OE scrap (inert)	1	Surface	Yes	1614835.00	2488825.00	CMS-OE, 1998	454	Stockpile Clearance
3	Yes	15 pounds OE scrap (inert)	1	Surface	Yes	1614835.00	2488820.00	CMS-OE, 1998	455	Stockpile Clearance
3	Yes	15 pounds OE scrap (inert)	1	Surface	Yes	1614835.00	2488815.00	CMS-OE, 1998	456	Stockpile Clearance
3	Yes	19,360 lbs. of OE Related Scrap	1	Surface	Yes	1614820.00	2488820.00	CMS-OE, 1998	457	Stockpile Clearance
3	Yes	2 pounds OE scrap (inert)	1	Surface	Yes	1614781.00	2488810.00	CMS-OE, 1998	458	Stockpile Clearance
3	Yes	20 pounds OE scrap (inert)	1	Surface	Yes	1614855.00	2488805.00	CMS-OE, 1998	459	Stockpile Clearance
3	Yes	20 pounds OE scrap (inert)	1	Surface	Yes	1614880.00	2488775.00	CMS-OE, 1998	460	Stockpile Clearance
3	Yes	20,823 lbs. of OE and NON-OE Related Scrap	1	Surface	Yes	1614805.00	2488920.00	CMS-OE, 1998	461	Stockpile Clearance
3	Yes	20mm Projectile	1	Surface	Yes	1614875.00	2488910.00	CMS-OE, 1998	462	Stockpile Clearance
3	Yes	20mm Projectile	1	Surface	Yes	1614800.00	2488910.00	CMS-OE, 1998	463	Stockpile Clearance
3	Yes	20mm Projectile APT	1	Surface	Yes	1614865.00	2488920.00	CMS-OE, 1998	464	Stockpile Clearance
3	Yes	20mm Projectile, HE	1	Surface	Yes	1614855.00	2488925.00	CMS-OE, 1998	465	Stockpile Clearance
3	Yes	20mm Projectile, HE	1	Surface	Yes	1614790.00	2488945.00	CMS-OE, 1998	466	Stockpile Clearance
3	Yes	20mm Projectile, HE	1	Surface	Yes	1614880.00	2488945.00	CMS-OE, 1998	467	Stockpile Clearance
3	Yes	20mm Tracer Projectile	1	Surface	Yes	1614875.00	2488945.00	CMS-OE, 1998	468	Stockpile Clearance
3	Yes	25 pounds OE scrap (inert)	1	Surface	Yes	1614870.00	2488945.00	CMS-OE, 1998	469	Stockpile Clearance
3	Yes	25LBS Frag Bomb	1	Surface	Yes	1614860.00	2488945.00	CMS-OE, 1998	470	Stockpile Clearance
3	Yes	3.5 Rocket Motor	1	Surface	Yes	1614781.00	2488970.00	CMS-OE, 1998	471	Stockpile Clearance
3	Yes	3.5" Rocket Base Fuze	1	Surface	Yes	1614785.00	2488950.00	CMS-OE, 1998	472	Stockpile Clearance
3	Yes	30 pounds OE scrap (inert)	1	Surface	Yes	1614900.00	2488850.00	CMS-OE, 1998	473	Stockpile Clearance
3	Yes	37mm Projectile	26	Surface	Yes	1614905.00	2488855.00	CMS-OE, 1998	474	Stockpile Clearance
3	Yes	37mm Projectile	31	Surface	Yes	1614905.00	2488855.00	CMS-OE, 1998	475	Stockpile Clearance
3	Yes	37mm Projectile	20	Surface	Yes	1614905.00	2488855.00	CMS-OE, 1998	476	Stockpile Clearance
3	Yes	37mm Projectile	5	Surface	Yes	1614905.00	2488855.00	CMS-OE, 1998	477	Stockpile Clearance
3	Yes	37mm Projectile	13	Surface	Yes	1614905.00	2188855.00	CMS-OE, 1998	478	Stockpile Clearance
3	Yes	37mm Projectile	3	Surface	Yes	1614905.00	2488855.00	CMS-OE, 1998	479	Stockpile Clearance
3	Yes	37mm Projectile	14	Surface	Yes	1614905.00	2488855.00	CMS-OE, 1998	480	Stockpile Clearance
3	Yes	37mm Projectile	12	Surface	Yes	1614905.00	2488855.00	CMS-OE, 1998	481	Stockpile Clearance
3	Yes	37mm Projectile	1	Surface	Yes	1614905.00	2488855.00	CMS-OE, 1998	482	Stockpile Clearance
3	Yes	37mm Projectile	5	Surface	Yes	1614905.00	2488855.00	CMS-OE, 1998	483	Stockpile Clearance
3	Yes	37mm Projectile	3	Surface	Yes	1614905.00	2488855.00	CMS-OE, 1998	484	Stockpile Clearance
3	Yes	37mm Projectile	1	Surface	Yes	1614905.00	2488855.00	CMS-OE, 1998	485	Stockpile Clearance
3	Yes	37mm Projectile APT	1	Surface	Yes	1614905.00	2488855.00	CMS-OE, 1998	486	Stockpile Clearance
3	Yes	37mm Tracer Projectile	1	Surface	Yes	1614970.00	2488805.00	CMS-OE, 1998	487	Stockpile Clearance

**Military Munitions Summary Table**  
**Parcel 3**  
**Fort Wingate Depot Activity**  
**Gallup, New Mexico**

Parcel No.	Removed	Item Description	Quantity	Depth (ft. BGS)	Mapped	Northing	Easting	Source	ID No.	Area Description
3	Yes	40 pounds OE scrap (inert)	1	Surface	Yes	1614920.00	2488960.00	CMS-OE, 1998	488	Stockpile Clearance
3	Yes	40mm	1	Surface	Yes	1614905.00	2488968.00	CMS-OE, 1998	489	Stockpile Clearance
3	Yes	40mm	1	Surface	Yes	1614925.00	2488965.00	CMS-OE, 1998	490	Stockpile Clearance
3	Yes	40mm Projectile	1	Surface	Yes	1614920.00	2488960.00	CMS-OE, 1998	491	Stockpile Clearance
3	Yes	40mm Projectile	1	Surface	Yes	1614980.00	2488950.00	CMS-OE, 1998	492	Stockpile Clearance
3	Yes	40mm Projectile	1	Surface	Yes	1614970.00	2488955.00	CMS-OE, 1998	493	Stockpile Clearance
3	Yes	40mm Projectile	1	Surface	Yes	1614910.00	2488955.00	CMS-OE, 1998	494	Stockpile Clearance
3	Yes	40mm Projectile	1	Surface	Yes	1614900.00	2488950.00	CMS-OE, 1998	495	Stockpile Clearance
3	Yes	40mm Projectile	1	Surface	Yes	1614895.00	2488950.00	CMS-OE, 1998	496	Stockpile Clearance
3	Yes	40mm Projectile	1	Surface	Yes	1614895.00	2488945.00	CMS-OE, 1998	497	Stockpile Clearance
3	Yes	40mm Projectile	1	Surface	Yes	1614892.00	2488950.00	CMS-OE, 1998	498	Stockpile Clearance
3	Yes	40mm Projectile	1	Surface	Yes	1614890.00	2488930.00	CMS-OE, 1998	499	Stockpile Clearance
3	Yes	40mm Projectile	1	Surface	Yes	1614910.00	2488930.00	CMS-OE, 1998	500	Stockpile Clearance
3	Yes	40mm Projectile	1	Surface	Yes	1614980.00	2488890.00	CMS-OE, 1998	501	Stockpile Clearance
3	Yes	40mm Projectile	1	Surface	Yes	1614940.00	2488940.00	CMS-OE, 1998	502	Stockpile Clearance
3	Yes	40mm Projectile	1	Surface	Yes	1614920.00	2488920.00	CMS-OE, 1998	503	Stockpile Clearance
3	Yes	40mm Projectile	1	Surface	Yes	1614955.00	2488900.00	CMS-OE, 1998	504	Stockpile Clearance
3	Yes	40mm Projectile	1	Surface	Yes	1614970.00	2488910.00	CMS-OE, 1998	505	Stockpile Clearance
3	Yes	40mm Projectile	1	Surface	Yes	1614950.00	2488905.00	CMS-OE, 1998	506	Stockpile Clearance
3	Yes	40mm Projectile	1	Surface	Yes	1614935.00	2488905.00	CMS-OE, 1998	507	Stockpile Clearance
3	Yes	40mm Projectile	1	Surface	Yes	1614905.00	2488900.00	CMS-OE, 1998	508	Stockpile Clearance
3	Yes	40mm Projectile	1	Surface	Yes	1614915.00	2488905.00	CMS-OE, 1998	509	Stockpile Clearance
3	Yes	40mm Projectile Fuze	1	Surface	Yes	1614975.00	2488880.00	CMS-OE, 1998	510	Stockpile Clearance
3	Yes	40mm Projectile Fuze	1	Surface	Yes	1614930.00	2488900.00	CMS-OE, 1998	511	Stockpile Clearance
3	Yes	40mm Projectile, HE	1	Surface	Yes	1614975.00	2488880.00	CMS-OE, 1998	512	Stockpile Clearance
3	Yes	40mm Projectile, HE	1	Surface	Yes	1614980.00	2488875.00	CMS-OE, 1998	513	Stockpile Clearance
3	Yes	40mm Projectile, HE	1	Surface	Yes	1614881.00	2488930.00	CMS-OE, 1998	514	Stockpile Clearance
3	Yes	40mm Projectile, HE	1	Surface	Yes	1614935.00	2488873.00	CMS-OE, 1998	515	Stockpile Clearance
3	Yes	40mm Projectile, HE	1	Surface	Yes	1614881.00	2488930.00	CMS-OE, 1998	516	Stockpile Clearance
3	Yes	40mm Projectile, HE	1	Surface	Yes	1614970.00	2488910.00	CMS-OE, 1998	517	Stockpile Clearance
3	Yes	40mm Tracer Projectile	1	Surface	Yes	1614935.00	2488905.00	CMS-OE, 1998	518	Stockpile Clearance
3	Yes	40mm Tracer Projectile	1	Surface	Yes	1614905.00	2488900.00	CMS-OE, 1998	519	Stockpile Clearance
3	Yes	40mm Tracer Projectile	1	Surface	Yes	1614950.00	2488905.00	CMS-OE, 1998	520	Stockpile Clearance
3	Yes	40mm Tracer Projectile	1	Surface	Yes	1614915.00	2488905.00	CMS-OE, 1998	521	Stockpile Clearance
3	Yes	40mm with HE	1	Surface	Yes	1614975.00	2488880.00	CMS-OE, 1998	522	Stockpile Clearance
3	Yes	40mm with HE	1	Surface	Yes	1614930.00	2488900.00	CMS-OE, 1998	523	Stockpile Clearance
3	Yes	5 pounds OE scrap (inert)	1	Surface	Yes	1614975.00	2488880.00	CMS-OE, 1998	524	Stockpile Clearance
3	Yes	5 pounds OE scrap (inert)	1	Surface	Yes	1614980.00	2488875.00	CMS-OE, 1998	525	Stockpile Clearance
3	Yes	5 pounds OE scrap (inert)	1	Surface	Yes	1612575.00	2486680.00	CMS-OE, 1998	526	Southern Security Fence Line Clearance
3	Yes	5 pounds OE scrap (inert)	1	Surface	Yes	1612243.00	2486888.00	CMS-OE, 1998	527	Southern Security Fence Line Clearance
3	Yes	50 Cal. With Tracer	1	Surface	Yes	1612126.00	2486958.00	CMS-OE, 1998	528	Southern Security Fence Line Clearance
3	Yes	57mm AP/HE	1	Surface	Yes	1611530.00	2487865.00	CMS-OE, 1998	529	Southern Security Fence Line Clearance
3	Yes	57mm AP/HE	1	Surface	Yes	1611426.00	2488955.00	CMS-OE, 1998	530	Southern Security Fence Line Clearance
3	Yes	57mm AP/HE	1	Surface	Yes	1611412.00	2489118.00	CMS-OE, 1998	531	Southern Security Fence Line Clearance
3	Yes	57mm AP/HE	1	Surface	Yes	1611340.00	2489894.00	CMS-OE, 1998	532	Southern Security Fence Line Clearance
3	Yes	57mm AP/HE	1	Surface	Yes	1611291.00	2490435.00	CMS-OE, 1998	533	Southern Security Fence Line Clearance
3	Yes	57mm AP/HE	1	Surface	Yes	1611290.00	2490479.00	CMS-OE, 1998	534	Southern Security Fence Line Clearance
3	Yes	60m Mortar	2	Surface	Yes	1611255.00	2490812.00	CMS-OE, 1998	535	Southern Security Fence Line Clearance
3	Yes	60mm Mortar	1	Surface	Yes	1613795.00	2491942.00	CMS-OE, 1998	536	Buffer Zone

**Military Munitions Summary Table**  
**Parcel 3**  
**Fort Wingate Depot Activity**  
**Gallup, New Mexico**

Parcel No.	Removed	Item Description	Quantity	Depth (ft. BGS)	Mapped	Northing	Easting	Source	ID No.	Area Description
3	Yes	60mm Mortar	1	Surface	Yes	1614238.00	2491947.00	CMS-OE, 1998	537	Buffer Zone
3	Yes	60mm Mortar	1	Surface	Yes	1614168.00	2491982.00	CMS-OE, 1998	538	Buffer Zone
3	Yes	60mm Mortar	1	Surface	Yes	1614218.00	2491971.00	CMS-OE, 1998	539	Buffer Zone
3	Yes	60mm Mortar	1	Surface	Yes	1614268.00	2491946.00	CMS-OE, 1998	540	Buffer Zone
3	Yes	60mm Mortar	1	Surface	Yes	1614113.00	2491927.00	CMS-OE, 1998	541	Buffer Zone
3	Yes	60mm Mortar	1	Surface	Yes	1614360.00	2491958.00	CMS-OE, 1998	542	Buffer Zone
3	Yes	60mm with HE	1	Surface	Yes	1614372.00	2491940.00	CMS-OE, 1998	543	Buffer Zone
3	Yes	75mm Projectile	1	Surface	Yes	1614387.00	2491933.00	CMS-OE, 1998	544	Buffer Zone
3	Yes	75mm Projectile	1	Surface	Yes	1614354.00	2491954.00	CMS-OE, 1998	545	Buffer Zone
3	Yes	75mm Projectile	1	Surface	Yes	1614666.00	2491920.00	CMS-OE, 1998	546	Buffer Zone
3	Yes	75mm Projectile	1	Surface	Yes	1614546.00	2491928.00	CMS-OE, 1998	547	Buffer Zone
3	Yes	75mm Projectile	1	Surface	Yes	1614566.00	2491879.00	CMS-OE, 1998	548	Buffer Zone
3	Yes	75mm Projectile	1	Surface	Yes	1614855.00	2491865.00	CMS-OE, 1998	549	Buffer Zone
3	Yes	75mm Projectile	1	Surface	Yes	1614836.00	2491949.00	CMS-OE, 1998	550	Buffer Zone
3	Yes	75mm Projectile	1	Surface	Yes	1614856.00	2491916.00	CMS-OE, 1998	551	Buffer Zone
3	Yes	75mm Projectile	1	Surface	Yes	1614716.00	2491916.00	CMS-OE, 1998	552	Buffer Zone
3	Yes	75mm Projectile	1	Surface	Yes	1612438.00	2488956.00	CMS-OE, 1998	553	Seismic Survey Line Clearance
3	Yes	90 MM	1	Surface	Yes	1612423.00	2488955.00	CMS-OE, 1998	554	Seismic Survey Line Clearance
3	Yes	90 MM	1	Surface	Yes	1612435.00	2488922.00	CMS-OE, 1998	555	Seismic Survey Line Clearance
3	Yes	90mm Projectile	1	4.0	Yes	1614599.00	2488272.00	CMS-OE, 1998	556	Seismic Survey Line Clearance
3	Yes	Adapter 3.2 Sec. Delay	1	Surface	Yes	1614599.00	2488321.00	CMS-OE, 1998	557	Seismic Survey Line Clearance
3	Yes	BLU-3	1	1.0	Yes	1619016.00	2488631.00	CMS-OE, 1998	558	Seismic Survey Line Clearance
3	Yes	BLU-3	1	1.0	Yes	1619002.00	2488647.00	CMS-OE, 1998	559	Seismic Survey Line Clearance
3	Yes	BLU-4 Detonator	1	0.5	Yes	1619016.00	2488660.00	CMS-OE, 1998	560	Seismic Survey Line Clearance
3	Yes	Bomb Frag (20 lbs.), AN/M41	1	1.0	Yes	1619081.00	2488085.00	CMS-OE, 1998	561	Seismic Survey Line Clearance
3	Yes	Bomb Frag (20 lbs.), AN/M41	1	6	Yes	1614845.01	2492090.32	EHSI, 1999	562	Grid Survey - Sector A - AL-2
3	Yes	Bomblet Fuze M130	1	6	Yes	1614871.04	2492469.78	EHSI, 1999	563	Grid Survey - Sector A - AL-3
3	Yes	Bomblet, BLU-4	1	8	Yes	1614752.40	2492460.75	EHSI, 1999	564	Grid Survey - Sector A - AL-3
3	Yes	Bomblet, M83 w/Fuze	1	6	Yes	1614923.08	2492278.13	EHSI, 1999	565	Grid Survey - Sector A - AL-3
3	Yes	Delay Element	1	13	Yes	1614884.57	2492460.75	EHSI, 1999	566	Grid Survey - Sector A - AL-3
3	Yes	Det Lead, M20 Fuze	1	8	Yes	1614891.86	2492456.73	EHSI, 1999	567	Grid Survey - Sector A - AL-3
3	Yes	Explosive C4	1	7	Yes	1614761.75	2492179.63	EHSI, 1999	568	Grid Survey - Sector A - AL-2
3	Yes	Explosive C4	1	6	Yes	1614916.73	2491935.24	EHSI, 1999	569	Grid Survey - Sector A - AL-1
3	Yes	Explosive C4	1	6	Yes	1614781.44	2492025.55	EHSI, 1999	570	Grid Survey - Sector A - AL-1
3	Yes	Fuze Booster Cup	1	8	Yes	1614906.33	2491995.45	EHSI, 1999	571	Grid Survey - Sector A - AL-1
3	Yes	Fuze Components	1	18	Yes	1614895.92	2491968.35	EHSI, 1999	572	Grid Survey - Sector A - AL-1
3	Yes	Fuze Detonator	1	6	Yes	1614253.08	2491966.67	EHSI, 1999	573	Grid Survey - Sector A - AH-1
3	Yes	Fuze Detonator XM 756	1	6	Yes	1614159.42	2491986.74	EHSI, 1999	574	Grid Survey - Sector A - AH-1
3	Yes	Fuze M111	1	4	Yes	1614211.45	2491976.71	EHSI, 1999	575	Grid Survey - Sector A - AH-1
3	Yes	Fuze M56 Rotary Det.	1	8	Yes	1613977.93	2491933.70	EHSI, 1999	576	Grid Survey - Sector A - AG-1
3	Yes	Fuze M56 Rotary Det.	1	8	Yes	1614283.69	2492892.88	EHSI, 1999	577	Grid Survey - Sector A - AH-6
3	Yes	Fuze VT Det Lead	1	6	Yes	1614689.19	2492675.49	EHSI, 1999	578	Grid Survey - Sector A - AK-5
3	Yes	M1 Burster	1	12	Yes	1614616.34	2492802.93	EHSI, 1999	579	Grid Survey - Sector A - AK-5
3	Yes	M103 Fuze	1	12	Yes	1613916.74	2492439.27	EHSI, 1999	580	Grid Survey - Sector A - AF-3
3	Yes	M103 Fuze	1	2	Yes	1614500.94	2492014.72	EHSI, 1999	581	Grid Survey - Sector A - AJ-1
3	Yes	M104 Fuze	1	4	Yes	1614172.88	2492811.94	EHSI, 1999	582	Grid Survey - Sector A - AG-5
3	Yes	M104 Fuze	1	3	Yes	1614645.31	2492085.19	EHSI, 1999	583	Grid Survey - Sector A - AK-2
3	Yes	M104 Fuze	1	5	Yes	1614728.56	2492083.18	EHSI, 1999	584	Grid Survey - Sector A - AK-2
3	Yes	M104 Fuze	1	3	Yes	1614740.01	2492080.17	EHSI, 1999	585	Grid Survey - Sector A - AK-2

**Military Munitions Summary Table**  
**Parcel 3**  
**Fort Wingate Depot Activity**  
**Gallup, New Mexico**

Parcel No.	Removed	Item Description	Quantity	Depth (ft. BGS)	Mapped	Northing	Easting	Source	ID No.	Area Description
3	Yes	M104 Fuze	1	6	Yes	1614600.56	2492264.80	EHSI, 1999	586	Grid Survey - Sector A - AK-2
3	Yes	M104 Fuze	1	4	Yes	1613993.17	2492650.74	EHSI, 1999	587	Grid Survey - Sector A - AG-4
3	Yes	M104 Fuze	1	3	Yes	1613721.53	2492308.89	EHSI, 1999	588	Grid Survey - Sector A - AE-3
3	Yes	M104 Fuze	1	8	Yes	1614156.43	2492290.79	EHSI, 1999	589	Grid Survey - Sector A - AH-3
3	Yes	M104 Fuze	1	3	Yes	1614177.25	2492451.33	EHSI, 1999	590	Grid Survey - Sector A - AH-3
3	Yes	M104 Fuze	1	6	Yes	1614322.95	2492441.30	EHSI, 1999	591	Grid Survey - Sector A - AH-3
3	Yes	M104 Fuze	1	1	Yes	1613730.20	2492217.66	EHSI, 1999	592	Grid Survey - Sector A - AE-2
3	Yes	M104 Fuze	1	1	Yes	1615093.56	2494380.50	EHSI, 1999	593	Transect Search Routes - Lane 1
3	Yes	M104 Fuze	1	unknown	No			EHSI, 1999		Grid Survey - Sector A
3	Yes	M104 Fuze	1	unknown	No			EHSI, 1999		Grid Survey - Sector A
3	Yes	M110A1 Fuze	1	unknown	No			EHSI, 1999		Grid Survey - Sector A - AA-1
3	Yes	M110A1 Fuze	1	unknown	No			EHSI, 1999		Grid Survey - Sector A - AA-1
3	Yes	M120 Fuze	1	unknown	No			EHSI, 1999		Grid Survey - Sector A - AA-1
3	Yes	M148 PD Fuze	1	unknown	No			EHSI, 1999		Grid Survey - Sector A - AA-1
3	Yes	M148 PD Fuze	1	unknown	No			EHSI, 1999		Grid Survey - Sector A - AB-4
3	Yes	M148 PD Fuze	1	unknown	No			EHSI, 1999		Grid Survey - Sector A - AB-4
3	Yes	M148 PD Fuze	1	unknown	No			EHSI, 1999		Grid Survey - Sector A - AB-4
3	Yes	M149 Fuze	1	unknown	No			EHSI, 1999		Grid Survey - Sector A - AB-6
3	Yes	M149 Fuze	1	unknown	No			EHSI, 1999		Grid Survey - Sector A - AB-6
3	Yes	M20 Booster	2	unknown	No			EHSI, 1999		Grid Survey - Sector A - AB-5
3	Yes	M28 Fuze	1	unknown	No			EHSI, 1999		Grid Survey - Sector A - AB-5
3	Yes	M38 Fuze	1	unknown	No			EHSI, 1999		Grid Survey - Sector A - AB-1
3	Yes	M40 mm	2	unknown	No			EHSI, 1999		Grid Survey - Sector A - AL-6
3	Yes	M404 Fuze	1	unknown	No			EHSI, 1999		Grid Survey - Sector A - AH-6
3	Yes	M404 Fuze	6	unknown	No			EHSI, 1999		Grid Survey - Sector A - AL-5
3	Yes	M404 Fuze	1	unknown	No			EHSI, 1999		Grid Survey - Sector A - AL-5
3	Yes	M404 Fuze	1	unknown	No			EHSI, 1999		Grid Survey - Sector A - AL-5
3	Yes	M404 Fuze	1	unknown	No			EHSI, 1999		Grid Survey - Sector A - AL-5
3	Yes	M404 Fuze	1	unknown	No			EHSI, 1999		Grid Survey - Sector A - AL-5
3	Yes	M404 Fuze	3	unknown	No			EHSI, 1999		Grid Survey - Sector A - AL-5
3	Yes	M404 Fuze	1	unknown	No			EHSI, 1999		Grid Survey - Sector A - AL-6
3	Yes	M404 Fuze	1	unknown	No			EHSI, 1999		Grid Survey - Sector A - AL-6
3	Yes	M48 Fuze	5	unknown	No			EHSI, 1999		Grid Survey - Sector A - AL-4
3	Yes	M48 Fuze	1	unknown	No			EHSI, 1999		Grid Survey - Sector A - AL-4
3	Yes	M48 Fuze	1	unknown	No			EHSI, 1999		Grid Survey - Sector A - AL-4
3	Yes	M48 Fuze	1	unknown	No			EHSI, 1999		Grid Survey - Sector A - AL-4
3	Yes	M48 Fuze	1	unknown	No			EHSI, 1999		Grid Survey - Sector A - AM-4
3	Yes	M48 Fuze	1	unknown	No			EHSI, 1999		Grid Survey - Sector A - BB-1
3	Yes	M48 Fuze	1	unknown	No			EHSI, 1999		Grid Survey - Sector A - AM-3
3	Yes	M48 Fuze	1	unknown	No			EHSI, 1999		Grid Survey - Sector A - AM-3
3	Yes	M48 Fuze	11	unknown	No			EHSI, 1999		Grid Survey - Sector A - AL-2
3	Yes	M48 Fuze	1	unknown	No			EHSI, 1999		Grid Survey - Sector A - AL-2
3	Yes	M48 Fuze	2	unknown	No			EHSI, 1999		Grid Survey - Sector A - AL-2
3	Yes	M48 Fuze	3	unknown	No			EHSI, 1999		Grid Survey - Sector A - AL-2
3	Yes	M48 Fuze	2	unknown	No			EHSI, 1999		Grid Survey - Sector A - AL-2
3	Yes	M48 Fuze	1	unknown	No			EHSI, 1999		Grid Survey - Sector A - AL-2
3	Yes	M48 Fuze	2	unknown	No			EHSI, 1999		Grid Survey - Sector A - AL-2
3	Yes	M48 Fuze	2	unknown	No			EHSI, 1999		Grid Survey - Sector A - AL-3
3	Yes	M48 Fuze	8	unknown	No			EHSI, 1999		Grid Survey - Sector A - AL-3

**Military Munitions Summary Table**  
**Parcel 3**  
**Fort Wingate Depot Activity**  
**Gallup, New Mexico**

Parcel No.	Removed	Item Description	Quantity	Depth (ft. BGS)	Mapped	Northing	Eastings	Source	ID No.	Area Description
3	Yes	M48 Fuze	2	unknown	No			EHSI, 1999		Grid Survey - Sector A - AL-3
3	Yes	M48 Fuze	1	unknown	No			EHSI, 1999		Grid Survey - Sector A - AL-3
3	Yes	M48 Fuze	2	unknown	No			EHSI, 1999		Grid Survey - Sector A - S2-28
3	Yes	M48 Fuze	2	unknown	No			EHSI, 1999		Grid Survey - Sector A - S2-29
3	Yes	M48 Fuze	1	unknown	No			EHSI, 1999		Grid Survey - Sector A - S2-29
3	Yes	M48 Fuze	1	unknown	No			EHSI, 1999		Grid Survey - Sector A - AM-2
3	Yes	M48 Fuze	1	unknown	No			EHSI, 1999		Grid Survey - Sector A - AM-2
3	Yes	M48 Fuze, SQ	1	unknown	No			EHSI, 1999		Grid Survey - Sector A - AM-2
3	Yes	M500 Series Fuze	3	unknown	No			EHSI, 1999		Grid Survey - Sector A - AL-1
3	Yes	M500 Series Fuze	3	unknown	No			EHSI, 1999		Grid Survey - Sector A - AL-1
3	Yes	M500 Series Fuze	5	unknown	No			EHSI, 1999		Grid Survey - Sector A - AL-1
3	Yes	M500 Series Fuze	1	unknown	No			EHSI, 1999		Grid Survey - Sector A - AL-1
3	Yes	M500 Series Fuze	1	unknown	No			EHSI, 1999		Grid Survey - Sector A - AL-1
3	Yes	M500 Series Fuze	1	unknown	No			EHSI, 1999		Grid Survey - Sector A - AL-1
3	Yes	M503 Fuze	1	unknown	No			EHSI, 1999		Grid Survey - Sector A - AH-1
3	Yes	M503A1 Fuze	4	unknown	No			EHSI, 1999		Grid Survey - Sector A - AH-1
3	Yes	M506 Fuze	5	unknown	No			EHSI, 1999		Grid Survey - Sector A - AH-1
3	Yes	M506 Fuze	3	unknown	No			EHSI, 1999		Grid Survey - Sector A - AH-1
3	Yes	M52 Fuze	1	unknown	No			EHSI, 1999		Grid Survey - Sector A - AH-1
3	Yes	M52A1 Fuze	1	unknown	No			EHSI, 1999		Grid Survey - Sector A - AH-1
3	Yes	M53 Fuze	1	unknown	No			EHSI, 1999		Grid Survey - Sector A - AH-1
3	Yes	M53 Fuze	4	unknown	No			EHSI, 1999		Grid Survey - Sector A - AM-1
3	Yes	M57 Fuze	1	unknown	No			EHSI, 1999		Grid Survey - Sector A - AG-1
3	Yes	M66 BD Fuze	1	unknown	No			EHSI, 1999		Grid Survey - Sector A - AG-1
3	Yes	M66 BD Fuze	2	unknown	No			EHSI, 1999		Grid Survey - Sector A - AG-1
3	Yes	M66 BD Fuze	1	unknown	No			EHSI, 1999		Grid Survey - Sector A - AE-1
3	Yes	M66 BD Fuze	4	unknown	No			EHSI, 1999		Grid Survey - Sector A - AE-1
3	Yes	M66 BD Fuze	2	unknown	No			EHSI, 1999		Grid Survey - Sector A - AE-1
3	Yes	M66 BD Fuze	1	unknown	No			EHSI, 1999		Grid Survey - Sector A - AE-1
3	Yes	M66 BD Fuze	1	unknown	No			EHSI, 1999		Grid Survey - Sector A - AE-1
3	Yes	M66 BD Fuze	1	unknown	No			EHSI, 1999		Grid Survey - Sector A - AE-1
3	Yes	M66 BD Fuze	1	unknown	No			EHSI, 1999		Grid Survey - Sector A - AE-1
3	Yes	M66 BD Fuze	1	unknown	No			EHSI, 1999		Grid Survey - Sector A - AF-2
3	Yes	M66 BD Fuze	2	unknown	No			EHSI, 1999		Grid Survey - Sector A - AF-2
3	Yes	M66 BD Fuze	1	unknown	No			EHSI, 1999		Grid Survey - Sector A - AF-2
3	Yes	M66 BD Fuze	1	unknown	No			EHSI, 1999		Grid Survey - Sector A - AF-2
3	Yes	M66 BD Fuze	2	unknown	No			EHSI, 1999		Grid Survey - Sector A - AF-2
3	Yes	M66 BD Fuze	3	unknown	No			EHSI, 1999		Grid Survey - Sector A - AG-2
3	Yes	M66 BD Fuze	1	unknown	No			EHSI, 1999		Grid Survey - Sector A - AG-2
3	Yes	M66 BD Fuze	1	unknown	No			EHSI, 1999		Grid Survey - Sector A - AG-2
3	Yes	M66 BD Fuze	1	unknown	No			EHSI, 1999		Grid Survey - Sector A - AG-2
3	Yes	M66 BD Fuze	2	unknown	No			EHSI, 1999		Grid Survey - Sector A - AG-2
3	Yes	M66 BD Fuze	1	unknown	No			EHSI, 1999		Grid Survey - Sector A - AG-2
3	Yes	M66 BD Fuze	1	unknown	No			EHSI, 1999		Grid Survey - Sector A - AK-6
3	Yes	M66 BD Fuze	1	unknown	No			EHSI, 1999		Grid Survey - Sector A - AK-6
3	Yes	M66 BD Fuze	3	unknown	No			EHSI, 1999		Grid Survey - Sector A - AJ-6
3	Yes	M66 BD Fuze	1	unknown	No			EHSI, 1999		Grid Survey - Sector A - AJ-6
3	Yes	M66 BD Fuze	1	unknown	No			EHSI, 1999		Grid Survey - Sector A - AH-6
3	Yes	M66 BD Fuze	5	unknown	No			EHSI, 1999		Grid Survey - Sector A - AK-5
3	Yes	M66 BD Fuze	2	unknown	No			EHSI, 1999		Grid Survey - Sector A - AK-5
3	Yes	M66 BD Fuze	1	unknown	No			EHSI, 1999		Grid Survey - Sector A - AK-5

**Military Munitions Summary Table**  
**Parcel 3**  
**Fort Wingate Depot Activity**  
**Gallup, New Mexico**

Parcel No.	Removed	Item Description	Quantity	Depth (ft. BGS)	Mapped	Northing	Easting	Source	ID No.	Area Description
3	Yes	M66 BD Fuze	1	unknown	No			EHSI, 1999		Grid Survey - Sector A - AK-5
3	Yes	M66 BD Fuze	1	unknown	No			EHSI, 1999		Grid Survey - Sector A - AJ-5
3	Yes	M66 BD Fuze	3	unknown	No			EHSI, 1999		Grid Survey - Sector A - AJ-5
3	Yes	M66 BD Fuze	1	unknown	No			EHSI, 1999		Grid Survey - Sector A - AJ-5
3	Yes	M66 BD Fuze	2	unknown	No			EHSI, 1999		Grid Survey - Sector A - AJ-5
3	Yes	M66 BD Fuze	1	unknown	No			EHSI, 1999		Grid Survey - Sector A - AH-5
3	Yes	M66 BD Fuze	1	unknown	No			EHSI, 1999		Grid Survey - Sector A - AH-5
3	Yes	M66 BD Fuze	1	unknown	No			EHSI, 1999		Grid Survey - Sector A - AH-5
3	Yes	M66 BD Fuze	4	unknown	No			EHSI, 1999		Grid Survey - Sector A - AG-3
3	Yes	M66 BD Fuze	3	unknown	No			EHSI, 1999		Grid Survey - Sector A - AG-3
3	Yes	M66 BD Fuze	1	unknown	No			EHSI, 1999		Grid Survey - Sector A - AG-3
3	Yes	M66 BD Fuze	2	unknown	No			EHSI, 1999		Grid Survey - Sector A - AK-1
3	Yes	M66 BD Fuze	3	unknown	No			EHSI, 1999		Grid Survey - Sector A - AK-1
3	Yes	M66 BD Fuze	3	unknown	No			EHSI, 1999		Grid Survey - Sector A - AK-1
3	Yes	M66 BD Fuze	1	unknown	No			EHSI, 1999		Grid Survey - Sector A - AK-1
3	Yes	M66 BD Fuze	1	unknown	No			EHSI, 1999		Grid Survey - Sector A - AH-4
3	Yes	M66 BD Fuze	1	unknown	No			EHSI, 1999		Grid Survey - Sector A - AH-4
3	Yes	M66 BD Fuze	1	unknown	No			EHSI, 1999		Grid Survey - Sector A - AH-4
3	Yes	M66 BD Fuze	2	unknown	No			EHSI, 1999		Grid Survey - Sector A - AH-4
3	Yes	M66 BD Fuze	1	unknown	No			EHSI, 1999		Grid Survey - Sector A - AJ-1
3	Yes	M66 BD Fuze	1	unknown	No			EHSI, 1999		Grid Survey - Sector A - AJ-1
3	Yes	M66 BD Fuze	2	unknown	No			EHSI, 1999		Grid Survey - Sector A - AJ-1
3	Yes	M66 BD Fuze	1	unknown	No			EHSI, 1999		Grid Survey - Sector A - AJ-1
3	Yes	M66 Fuze	2	unknown	No			EHSI, 1999		Grid Survey - Sector A - AJ-1
3	Yes	M66 Fuze	3	unknown	No			EHSI, 1999		Grid Survey - Sector A - AD-1
3	Yes	M66 Fuze	2	unknown	No			EHSI, 1999		Grid Survey - Sector A - AH-2
3	Yes	M66 Fuze	2	unknown	No			EHSI, 1999		Grid Survey - Sector A - AH-2
3	Yes	M66 Fuze	1	unknown	No			EHSI, 1999		Grid Survey - Sector A - AH-2
3	Yes	M66 Fuze	1	unknown	No			EHSI, 1999		Grid Survey - Sector A - AH-2
3	Yes	M66 Fuze	1	unknown	No			EHSI, 1999		Grid Survey - Sector A - AH-2
3	Yes	M67 Fuze	2	unknown	No			EHSI, 1999		Grid Survey - Sector A - AE-5
3	Yes	M68 Fuze	4	unknown	No			EHSI, 1999		Grid Survey - Sector A - AE-6
3	Yes	M68 Fuze	1	unknown	No			EHSI, 1999		Grid Survey - Sector A - AE-6
3	Yes	M68 Fuze	9	unknown	No			EHSI, 1999		Grid Survey - Sector A - AK-4
3	Yes	M68 Fuze	3	unknown	No			EHSI, 1999		Grid Survey - Sector A - AK-4
3	Yes	M68 Fuze	2	unknown	No			EHSI, 1999		Grid Survey - Sector A - AK-4
3	Yes	M68 Fuze	1	unknown	No			EHSI, 1999		Grid Survey - Sector A - AK-4
3	Yes	M68 Fuze	3	unknown	No			EHSI, 1999		Grid Survey - Sector A - AK-4
3	Yes	M68 Fuze	10	unknown	No			EHSI, 1999		Grid Survey - Sector A - AJ-4
3	Yes	M68 Fuze	1	unknown	No			EHSI, 1999		Grid Survey - Sector A - AJ-4
3	Yes	M68 Fuze	1	unknown	No			EHSI, 1999		Grid Survey - Sector A - AG-5
3	Yes	M68 Fuze	1	unknown	No			EHSI, 1999		Grid Survey - Sector A - AG-6
3	Yes	M68 Fuze	3	unknown	No			EHSI, 1999		Grid Survey - Sector A - AG-4
3	Yes	M68 Fuze	3	unknown	No			EHSI, 1999		Grid Survey - Sector A - AG-4
3	Yes	M68 Fuze	1	unknown	No			EHSI, 1999		Grid Survey - Sector A - AG-4
3	Yes	M68 Fuze	1	unknown	No			EHSI, 1999		Grid Survey - Sector A - AG-4
3	Yes	M68 Fuze	1	unknown	No			EHSI, 1999		Grid Survey - Sector A - AG-4
3	Yes	M68 Fuze	1	unknown	No			EHSI, 1999		Grid Survey - Sector A - AF-5
3	Yes	M68 Fuze	2	unknown	No			EHSI, 1999		Grid Survey - Sector A - AE-3



**Military Munitions Summary Table**  
**Parcel 3**  
**Fort Wingate Depot Activity**  
**Gallup, New Mexico**

Parcel No.	Removed	Item Description	Quantity	Depth (ft. BGS)	Mapped	Northing	Easting	Source	ID No.	Area Description
3	Yes	M68 Fuze	1	unknown	No			EHSI, 1999		Grid Survey - Sector A - AE-3
3	Yes	M68 Fuze	1	unknown	No			EHSI, 1999		Grid Survey - Sector A - AE-4
3	Yes	M68 Fuze	1	unknown	No			EHSI, 1999		Grid Survey - Sector A - AE-4
3	Yes	M68 Fuze	1	unknown	No			EHSI, 1999		Grid Survey - Sector A - AJ-2
3	Yes	M68 Fuze	7	unknown	No			EHSI, 1999		Grid Survey - Sector A - AJ-2
3	Yes	M68 Fuze	6	unknown	No			EHSI, 1999		Grid Survey - Sector A - AJ-2
3	Yes	M68 Fuze	2	unknown	No			EHSI, 1999		Grid Survey - Sector A - AJ-2
3	Yes	M68 Fuze	1	unknown	No			EHSI, 1999		Grid Survey - Sector A - AD-5
3	Yes	M72 Fuze	1	unknown	No			EHSI, 1999		Grid Survey - Sector A - AD-5
3	Yes	M72 Fuze	1	unknown	No			EHSI, 1999		Grid Survey - Sector A - AD-5
3	Yes	M72 Fuze	1	unknown	No			EHSI, 1999		Grid Survey - Sector A - AH-3
3	Yes	M72 Fuze	1	unknown	No			EHSI, 1999		Grid Survey - Sector A - AH-3
3	Yes	M72 Fuze	1	unknown	No			EHSI, 1999		Grid Survey - Sector A - AH-3
3	Yes	M72 Fuze	1	unknown	No			EHSI, 1999		Grid Survey - Sector A - AD-4
3	Yes	M72 Fuze	1	unknown	No			EHSI, 1999		Grid Survey - Sector A - AD-4
3	Yes	M72 Fuze	2	unknown	No			EHSI, 1999		Grid Survey - Sector A - AD-3
3	Yes	M72 Fuze	2	unknown	No			EHSI, 1999		Grid Survey - Sector A - AJ-3
3	Yes	M72 Fuze	1	unknown	No			EHSI, 1999		Grid Survey - Sector A - AJ-3
3	Yes	M72 Fuze	2	unknown	No			EHSI, 1999		Grid Survey - Sector A - AK-3
3	Yes	M72 Fuze	2	unknown	No			EHSI, 1999		Grid Survey - Sector A - AK-3
3	Yes	M72 Fuze	1	unknown	No			EHSI, 1999		Grid Survey - Sector A - AD-2
3	Yes	M72 Fuze	1	unknown	No			EHSI, 1999		Grid Survey - Sector A - AG-7
3	Yes	M72 Fuze	2	unknown	No			EHSI, 1999		Transect Search Routes - Lane 1
3	Yes	M72 Fuze		0 - 1'	Yes	1611898.19	2485923.21	USA, 2001	594	Western Boundary Fence Line - Grid S 11
3	Yes	M72 Fuze		0 - 1'	Yes	1612096.73	2485917.94	USA, 2001	595	Western Boundary Fence Line - Grid S 12
3	Yes	M72 Fuze		0 - 1'	Yes	1612695.87	2485933.10	USA, 2001	596	Western Boundary Fence Line - Grid S 15
3	Yes	M72 Fuze		0 - 1'	Yes	1612894.81	2485937.04	USA, 2001	597	Western Boundary Fence Line - Grid S 16
3	Yes	M72 Fuze		0 - 1'	Yes	1613052.76	2485947.03	USA, 2001	598	Western Boundary Fence Line - Grid S 17
3	Yes	M72 Fuze		0 - 1'	Yes	1613483.89	2485951.30	USA, 2001	599	Western Boundary Fence Line - Grid S 19
3	Yes	M72 Fuze		0 - 1'	Yes	1613668.36	2485949.16	USA, 2001	600	Western Boundary Fence Line - Grid S 20
3	Yes	M72 Fuze		0 - 1'	Yes	1616735.45	2486116.97	USA, 2001	617	Western Boundary Fence Line - Grid N 3
3	Yes	M83 Butterfly comp.		0 - 1'	Yes	1616925.03	2486133.62	USA, 2001	618	Western Boundary Fence Line - Grid N 4
3	Yes	M83 Butterfly comp.		0 - 1'	Yes	1617125.14	2486151.88	USA, 2001	619	Western Boundary Fence Line - Grid N 5
3	Yes	MK 149 Fuze		0 - 1'	Yes	1617323.43	2486170.70	USA, 2001	620	Western Boundary Fence Line - Grid N 6
3	Yes	MK 149 Fuze		0 - 1'	Yes	1617522.77	2486185.49	USA, 2001	621	Western Boundary Fence Line - Grid N 7
3	Yes	MK 149 Fuze		0 - 1'	Yes	1617717.40	2486202.50	USA, 2001	622	Western Boundary Fence Line - Grid N 8
3	Yes	MK 149 Fuze		0 - 1'	Yes	1617906.22	2486220.23	USA, 2001	623	Western Boundary Fence Line - Grid N 9
3	Yes	MK 149 Fuze		0 - 1'	Yes	1618102.87	2486237.77	USA, 2001	624	Western Boundary Fence Line - Grid N 10
3	Yes	MK 149 Fuze		0 - 1'	Yes	1618303.93	2486254.25	USA, 2001	625	Western Boundary Fence Line - Grid N 11
3	Yes	MK 149 Fuze		0 - 1'	Yes	1618492.07	2486272.80	USA, 2001	626	Western Boundary Fence Line - Grid N 12
3	Yes	MK 149 Fuze		0 - 1'	Yes	1618530.72	2486326.51	USA, 2001	627	Western Boundary Fence Line - Grid N 13
3	Yes	MK 149 Fuze		0 - 1'	Yes	1618727.75	2486307.92	USA, 2001	628	Western Boundary Fence Line - Grid N 14
3	Yes	MK 149 Fuze		0 - 1'	Yes	1618921.35	2486307.46	USA, 2001	629	Western Boundary Fence Line - Grid N 15
3	Yes	MK 149 Fuze		0 - 1'	Yes	1619133.80	2486330.51	USA, 2001	630	Western Boundary Fence Line - Grid N 16
3	Yes	Primer Cartridge		0 - 1'	Yes	1619318.24	2486343.58	USA, 2001	631	Western Boundary Fence Line - Grid N 17
3	Yes	Primers Unknown		0 - 1'	Yes	1620705.79	2486465.72	USA, 2001	632	Western Boundary Fence Line - Grid N 24
3	Yes	Projectile Fuze Comp.		0 - 1'	Yes	1621679.91	2486578.75	USA, 2001	633	Western Boundary Fence Line - Grid N 29
3	Yes	Projo 20mm HET		0 - 1'	Yes	1622257.02	2486652.71	USA, 2001	634	Western Boundary Fence Line - Grid N 32
3	Yes	918 Blow-in-Place items include: 40mm	1	0 - 6"	Yes	1616662.70	2487093.99	UXB, 1993	640	Current and Closed OB/OD Areas

**Military Munitions Summary Table**  
**Parcel 3**  
**Fort Wingate Depot Activity**  
**Gallup, New Mexico**

Parcel No.	Removed	Item Description	Quantity	Depth (ft. BGS)	Mapped	Northing	Easting	Source	ID No.	Area Description
3	Yes	Projectile (5), 57mm Projectile (3), 60mm Mortar (1), 75mm Projectile (1), 81mm Mortar (1), PG-9 Rocket (1), 5" Zuni Rocket Warhead (1), 20LB. Frag Bomb (3), BLU-3 Bomblet (96), BLU-4 Bomblet (259), and M83 Butterfly Bomblet (547). Locations for 656 items have been mapped, the remaining 262 locations are unknown.	1	0 - 6"	Yes	1616652.05	2487153.18	UXB, 1993	641	Current and Closed OB/OD Areas
3	Yes		1	0 - 6"	Yes	1616587.06	2487231.30	UXB, 1993	642	Current and Closed OB/OD Areas
3	Yes		1	0 - 6"	Yes	1616448.26	2487221.89	UXB, 1993	643	Current and Closed OB/OD Areas
3	Yes		1	0 - 6"	Yes	1616390.67	2487293.23	UXB, 1993	644	Current and Closed OB/OD Areas
3	Yes		1	0 - 6"	Yes	1615827.14	2487283.62	UXB, 1993	645	Current and Closed OB/OD Areas
3	Yes		1	0 - 6"	Yes	1615822.42	2487358.70	UXB, 1993	646	Current and Closed OB/OD Areas
3	Yes		1	0 - 6"	Yes	1616473.89	2487382.11	UXB, 1993	647	Current and Closed OB/OD Areas
3	Yes		1	0 - 6"	Yes	1616530.52	2487386.50	UXB, 1993	648	Current and Closed OB/OD Areas
3	Yes		1	0 - 6"	Yes	1616633.15	2487367.80	UXB, 1993	649	Current and Closed OB/OD Areas
3	Yes		1	0 - 6"	Yes	1615969.55	2487437.14	UXB, 1993	650	Current and Closed OB/OD Areas
3	Yes		1	0 - 6"	Yes	1615921.98	2487431.26	UXB, 1993	651	Current and Closed OB/OD Areas
3	Yes		1	0 - 6"	Yes	1615856.58	2487432.65	UXB, 1993	652	Current and Closed OB/OD Areas
3	Yes		1	0 - 6"	Yes	1616002.87	2487508.68	UXB, 1993	653	Current and Closed OB/OD Areas
3	Yes		1	0 - 6"	Yes	1616060.34	2487504.58	UXB, 1993	654	Current and Closed OB/OD Areas
3	Yes		1	0 - 6"	Yes	1616129.63	2487511.89	UXB, 1993	655	Current and Closed OB/OD Areas
3	Yes		1	0 - 6"	Yes	1616692.48	2487537.08	UXB, 1993	656	Current and Closed OB/OD Areas
3	Yes		1	0 - 6"	Yes	1616767.22	2487603.35	UXB, 1993	657	Current and Closed OB/OD Areas
3	Yes		1	0 - 6"	Yes	1616825.11	2487600.68	UXB, 1993	658	Current and Closed OB/OD Areas
3	Yes		1	0 - 6"	Yes	1616332.65	2487676.12	UXB, 1993	659	Current and Closed OB/OD Areas
3	Yes		1	0 - 6"	Yes	1616488.36	2487774.82	UXB, 1993	660	Current and Closed OB/OD Areas
3	Yes		1	0 - 6"	Yes	1615882.30	2487763.35	UXB, 1993	661	Current and Closed OB/OD Areas
3	Yes		1	0 - 6"	Yes	1616555.37	2487866.31	UXB, 1993	662	Current and Closed OB/OD Areas
3	Yes		1	0 - 6"	Yes	1616635.55	2487862.73	UXB, 1993	663	Current and Closed OB/OD Areas
3	Yes		1	0 - 6"	Yes	1616822.31	2487869.04	UXB, 1993	664	Current and Closed OB/OD Areas
3	Yes		1	0 - 6"	Yes	1616633.92	2487932.26	UXB, 1993	665	Current and Closed OB/OD Areas
3	Yes		1	0 - 6"	Yes	1616490.51	2487930.70	UXB, 1993	666	Current and Closed OB/OD Areas
3	Yes		1	0 - 6"	Yes	1616074.79	2487908.65	UXB, 1993	667	Current and Closed OB/OD Areas
3	Yes	1	0 - 6"	Yes	1616062.46	2487952.14	UXB, 1993	668	Current and Closed OB/OD Areas	
3	Yes	1	0 - 6"	Yes	1615803.17	2487936.96	UXB, 1993	669	Current and Closed OB/OD Areas	
3	Yes	1	0 - 6"	Yes	1615037.24	2487738.06	UXB, 1993	670	Current and Closed OB/OD Areas	
3	Yes	1	0 - 6"	Yes	1615050.47	2487781.73	UXB, 1993	671	Current and Closed OB/OD Areas	
3	Yes	1	0 - 6"	Yes	1614978.30	2487764.83	UXB, 1993	672	Current and Closed OB/OD Areas	
3	Yes	1	0 - 6"	Yes	1615497.53	2487898.91	UXB, 1993	673	Current and Closed OB/OD Areas	
3	Yes	1	0 - 6"	Yes	1615641.03	2487833.72	UXB, 1993	674	Current and Closed OB/OD Areas	
3	Yes	1	0 - 6"	Yes	1615552.63	2487841.20	UXB, 1993	675	Current and Closed OB/OD Areas	
3	Yes	1	0 - 6"	Yes	1615611.69	2487779.40	UXB, 1993	676	Current and Closed OB/OD Areas	
3	Yes	1	0 - 6"	Yes	1615327.36	2487795.32	UXB, 1993	677	Current and Closed OB/OD Areas	
3	Yes	1	0 - 6"	Yes	1615242.73	2487759.87	UXB, 1993	678	Current and Closed OB/OD Areas	
3	Yes	1	0 - 6"	Yes	1615179.73	2487760.42	UXB, 1993	679	Current and Closed OB/OD Areas	
3	Yes	1	0 - 6"	Yes	1615011.90	2487829.76	UXB, 1993	680	Current and Closed OB/OD Areas	
3	Yes	1	0 - 6"	Yes	1614939.09	2487762.63	UXB, 1993	681	Current and Closed OB/OD Areas	
3	Yes	1	0 - 6"	Yes	1614864.31	2487783.50	UXB, 1993	682	Current and Closed OB/OD Areas	
3	Yes	1	0 - 6"	Yes	1614950.56	2487717.21	UXB, 1993	683	Current and Closed OB/OD Areas	
3	Yes	1	0 - 6"	Yes	1614883.32	2487727.98	UXB, 1993	684	Current and Closed OB/OD Areas	
3	Yes	1	0 - 6"	Yes	1614834.53	2487739.10	UXB, 1993	685	Current and Closed OB/OD Areas	
3	Yes	1	0 - 6"	Yes	1614804.01	2487743.91	UXB, 1993	686	Current and Closed OB/OD Areas	
3	Yes	1	0 - 6"	Yes	1614862.93	2487685.42	UXB, 1993	687	Current and Closed OB/OD Areas	
3	Yes	1	0 - 6"	Yes	1614981.48	2487670.74	UXB, 1993	688	Current and Closed OB/OD Areas	
3	Yes	1	0 - 6"	Yes	1615079.37	2487673.62	UXB, 1993	689	Current and Closed OB/OD Areas	

**Military Munitions Summary Table**  
**Parcel 3**  
**Fort Wingate Depot Activity**  
**Gallup, New Mexico**

Parcel No.	Removed	Item Description	Quantity	Depth (ft. BGS)	Mapped	Northing	Easting	Source	ID No.	Area Description
3	Yes		1	0 - 6"	Yes	1615215.35	2487704.22	UXB, 1993	690	Current and Closed OB/OD Areas
3	Yes		1	0 - 6"	Yes	1615256.10	2487703.64	UXB, 1993	691	Current and Closed OB/OD Areas
3	Yes		1	0 - 6"	Yes	1615328.35	2487740.43	UXB, 1993	692	Current and Closed OB/OD Areas
3	Yes		1	0 - 6"	Yes	1615419.75	2487740.19	UXB, 1993	693	Current and Closed OB/OD Areas
3	Yes		1	0 - 6"	Yes	1615677.65	2487689.96	UXB, 1993	694	Current and Closed OB/OD Areas
3	Yes		1	0 - 6"	Yes	1615206.11	2487634.20	UXB, 1993	695	Current and Closed OB/OD Areas
3	Yes		1	0 - 6"	Yes	1615147.41	2487623.10	UXB, 1993	696	Current and Closed OB/OD Areas
3	Yes		1	0 - 6"	Yes	1615092.79	2487626.86	UXB, 1993	697	Current and Closed OB/OD Areas
3	Yes		1	0 - 6"	Yes	1615056.57	2487621.48	UXB, 1993	698	Current and Closed OB/OD Areas
3	Yes		1	0 - 6"	Yes	1614939.48	2487624.38	UXB, 1993	699	Current and Closed OB/OD Areas
3	Yes		1	0 - 6"	Yes	1614867.72	2487630.23	UXB, 1993	700	Current and Closed OB/OD Areas
3	Yes		1	0 - 6"	Yes	1614940.22	2487575.17	UXB, 1993	701	Current and Closed OB/OD Areas
3	Yes		1	0 - 6"	Yes	1615314.01	2487592.54	UXB, 1993	702	Current and Closed OB/OD Areas
3	Yes		1	0 - 6"	Yes	1615422.22	2487629.97	UXB, 1993	703	Current and Closed OB/OD Areas
3	Yes		1	0 - 6"	Yes	1615569.05	2487639.73	UXB, 1993	704	Current and Closed OB/OD Areas
3	Yes		1	0 - 6"	Yes	1615554.02	2487572.30	UXB, 1993	705	Current and Closed OB/OD Areas
3	Yes		1	0 - 6"	Yes	1615488.37	2487568.47	UXB, 1993	706	Current and Closed OB/OD Areas
3	Yes		1	0 - 6"	Yes	1615371.67	2487551.98	UXB, 1993	707	Current and Closed OB/OD Areas
3	Yes		1	0 - 6"	Yes	1615206.78	2487522.01	UXB, 1993	708	Current and Closed OB/OD Areas
3	Yes		1	0 - 6"	Yes	1615082.18	2487512.75	UXB, 1993	709	Current and Closed OB/OD Areas
3	Yes		1	0 - 6"	Yes	1615003.93	2487515.47	UXB, 1993	710	Current and Closed OB/OD Areas
3	Yes		1	0 - 6"	Yes	1614947.46	2487518.19	UXB, 1993	711	Current and Closed OB/OD Areas
3	Yes		1	0 - 6"	Yes	1615184.67	2487475.58	UXB, 1993	712	Current and Closed OB/OD Areas
3	Yes		1	0 - 6"	Yes	1615090.64	2487470.98	UXB, 1993	713	Current and Closed OB/OD Areas
3	Yes		1	0 - 6"	Yes	1615037.44	2487474.80	UXB, 1993	714	Current and Closed OB/OD Areas
3	Yes		1	0 - 6"	Yes	1614958.99	2487471.35	UXB, 1993	715	Current and Closed OB/OD Areas
3	Yes		1	0 - 6"	Yes	1614911.77	2487468.33	UXB, 1993	716	Current and Closed OB/OD Areas
3	Yes		1	0 - 6"	Yes	1614799.38	2487439.72	UXB, 1993	717	Current and Closed OB/OD Areas
3	Yes		1	0 - 6"	Yes	1615088.76	2487416.91	UXB, 1993	718	Current and Closed OB/OD Areas
3	Yes		1	0 - 6"	Yes	1615237.83	2487418.73	UXB, 1993	719	Current and Closed OB/OD Areas
3	Yes		1	0 - 6"	Yes	1615399.39	2487449.03	UXB, 1993	720	Current and Closed OB/OD Areas
3	Yes		1	0 - 6"	Yes	1615304.90	2487379.53	UXB, 1993	721	Current and Closed OB/OD Areas
3	Yes		1	0 - 6"	Yes	1615392.62	2487376.76	UXB, 1993	722	Current and Closed OB/OD Areas
3	Yes		1	0 - 6"	Yes	1615492.15	2487342.30	UXB, 1993	723	Current and Closed OB/OD Areas
3	Yes		1	0 - 6"	Yes	1615369.12	2487318.90	UXB, 1993	724	Current and Closed OB/OD Areas
3	Yes		1	0 - 6"	Yes	1615316.82	2487323.71	UXB, 1993	725	Current and Closed OB/OD Areas
3	Yes		1	0 - 6"	Yes	1615214.66	2487321.11	UXB, 1993	726	Current and Closed OB/OD Areas
3	Yes		1	0 - 6"	Yes	1615290.05	2487264.76	UXB, 1993	727	Current and Closed OB/OD Areas
3	Yes		1	0 - 6"	Yes	1615372.14	2487271.68	UXB, 1993	728	Current and Closed OB/OD Areas
3	Yes		1	0 - 6"	Yes	1615478.19	2487272.08	UXB, 1993	729	Current and Closed OB/OD Areas
3	Yes		1	0 - 6"	Yes	1615580.72	2487287.95	UXB, 1993	730	Current and Closed OB/OD Areas
3	Yes		1	0 - 6"	Yes	1615707.31	2487294.93	UXB, 1993	731	Current and Closed OB/OD Areas
3	Yes		1	0 - 6"	Yes	1615707.67	2487232.92	UXB, 1993	732	Current and Closed OB/OD Areas
3	Yes		1	0 - 6"	Yes	1615284.40	2487220.95	UXB, 1993	733	Current and Closed OB/OD Areas
3	Yes		1	0 - 6"	Yes	1615211.54	2487219.64	UXB, 1993	734	Current and Closed OB/OD Areas
3	Yes		1	0 - 6"	Yes	1615133.02	2487228.51	UXB, 1993	735	Current and Closed OB/OD Areas
3	Yes		1	0 - 6"	Yes	1614925.11	2487240.21	UXB, 1993	736	Current and Closed OB/OD Areas
3	Yes		1	0 - 6"	Yes	1614855.77	2487255.63	UXB, 1993	737	Current and Closed OB/OD Areas
3	Yes		1	0 - 6"	Yes	1615245.46	2487180.41	UXB, 1993	738	Current and Closed OB/OD Areas

**Military Munitions Summary Table**  
**Parcel 3**  
**Fort Wingate Depot Activity**  
**Gallup, New Mexico**

Parcel No.	Removed	Item Description	Quantity	Depth (ft. BGS)	Mapped	Northing	Easting	Source	ID No.	Area Description
3	Yes		1	0 - 6"	Yes	1615301.77	2487170.57	UXB, 1993	739	Current and Closed OB/OD Areas
3	Yes		1	0 - 6"	Yes	1615352.59	2487167.12	UXB, 1993	740	Current and Closed OB/OD Areas
3	Yes		1	0 - 6"	Yes	1615597.46	2487176.46	UXB, 1993	741	Current and Closed OB/OD Areas
3	Yes		1	0 - 6"	Yes	1615649.34	2487127.13	UXB, 1993	742	Current and Closed OB/OD Areas
3	Yes		1	0 - 6"	Yes	1615104.09	2487121.64	UXB, 1993	743	Current and Closed OB/OD Areas
3	Yes		1	0 - 6"	Yes	1613936.30	2488158.95	UXB, 1993	744	Current and Closed OB/OD Areas
3	Yes		1	0 - 6"	Yes	1613991.99	2488141.51	UXB, 1993	745	Current and Closed OB/OD Areas
3	Yes		1	0 - 6"	Yes	1614110.92	2488150.52	UXB, 1993	746	Current and Closed OB/OD Areas
3	Yes		1	0 - 6"	Yes	1614580.41	2487929.65	UXB, 1993	747	Current and Closed OB/OD Areas
3	Yes		1	0 - 6"	Yes	1614641.13	2487873.13	UXB, 1993	748	Current and Closed OB/OD Areas
3	Yes		1	0 - 6"	Yes	1614693.03	2487834.22	UXB, 1993	749	Current and Closed OB/OD Areas
3	Yes		1	0 - 6"	Yes	1614712.26	2487763.09	UXB, 1993	750	Current and Closed OB/OD Areas
3	Yes		1	0 - 6"	Yes	1614650.73	2487816.26	UXB, 1993	751	Current and Closed OB/OD Areas
3	Yes		1	0 - 6"	Yes	1614221.81	2488083.89	UXB, 1993	752	Current and Closed OB/OD Areas
3	Yes		1	0 - 6"	Yes	1614150.40	2488092.59	UXB, 1993	753	Current and Closed OB/OD Areas
3	Yes		1	0 - 6"	Yes	1613896.61	2488081.44	UXB, 1993	754	Current and Closed OB/OD Areas
3	Yes		1	0 - 6"	Yes	1614008.01	2488067.87	UXB, 1993	755	Current and Closed OB/OD Areas
3	Yes		1	0 - 6"	Yes	1614310.41	2488039.48	UXB, 1993	756	Current and Closed OB/OD Areas
3	Yes		1	0 - 6"	Yes	1614514.53	2487887.93	UXB, 1993	757	Current and Closed OB/OD Areas
3	Yes		1	0 - 6"	Yes	1614687.41	2487735.95	UXB, 1993	758	Current and Closed OB/OD Areas
3	Yes		1	0 - 6"	Yes	1614578.97	2487789.90	UXB, 1993	759	Current and Closed OB/OD Areas
3	Yes		1	0 - 6"	Yes	1614070.91	2488015.70	UXB, 1993	760	Current and Closed OB/OD Areas
3	Yes		1	0 - 6"	Yes	1613931.36	2488034.20	UXB, 1993	761	Current and Closed OB/OD Areas
3	Yes		1	0 - 6"	Yes	1613927.32	2487986.19	UXB, 1993	762	Current and Closed OB/OD Areas
3	Yes		1	0 - 6"	Yes	1614044.90	2487971.95	UXB, 1993	763	Current and Closed OB/OD Areas
3	Yes		1	0 - 6"	Yes	1614142.28	2487964.86	UXB, 1993	764	Current and Closed OB/OD Areas
3	Yes		1	0 - 6"	Yes	1614537.01	2487753.49	UXB, 1993	765	Current and Closed OB/OD Areas
3	Yes		1	0 - 6"	Yes	1614592.20	2487715.20	UXB, 1993	766	Current and Closed OB/OD Areas
3	Yes		1	0 - 6"	Yes	1614659.98	2487670.35	UXB, 1993	767	Current and Closed OB/OD Areas
3	Yes		1	0 - 6"	Yes	1614724.12	2487622.50	UXB, 1993	768	Current and Closed OB/OD Areas
3	Yes		1	0 - 6"	Yes	1614392.74	2487825.28	UXB, 1993	769	Current and Closed OB/OD Areas
3	Yes		1	0 - 6"	Yes	1614143.17	2487912.34	UXB, 1993	770	Current and Closed OB/OD Areas
3	Yes		1	0 - 6"	Yes	1613962.60	2487926.66	UXB, 1993	771	Current and Closed OB/OD Areas
3	Yes		1	0 - 6"	Yes	1613895.12	2487889.13	UXB, 1993	772	Current and Closed OB/OD Areas
3	Yes		1	0 - 6"	Yes	1614116.97	2487861.94	UXB, 1993	773	Current and Closed OB/OD Areas
3	Yes		1	0 - 6"	Yes	1614325.21	2487810.48	UXB, 1993	774	Current and Closed OB/OD Areas
3	Yes		1	0 - 6"	Yes	1614706.30	2487532.22	UXB, 1993	775	Current and Closed OB/OD Areas
3	Yes		1	0 - 6"	Yes	1613880.49	2487790.94	UXB, 1993	776	Current and Closed OB/OD Areas
3	Yes		1	0 - 6"	Yes	1614412.21	2487641.00	UXB, 1993	777	Current and Closed OB/OD Areas
3	Yes		1	0 - 6"	Yes	1614498.24	2487590.32	UXB, 1993	778	Current and Closed OB/OD Areas
3	Yes		1	0 - 6"	Yes	1614661.27	2487468.69	UXB, 1993	779	Current and Closed OB/OD Areas
3	Yes		1	0 - 6"	Yes	1614716.39	2487442.70	UXB, 1993	780	Current and Closed OB/OD Areas
3	Yes		1	0 - 6"	Yes	1614335.32	2487623.41	UXB, 1993	781	Current and Closed OB/OD Areas
3	Yes		1	0 - 6"	Yes	1614120.94	2487717.69	UXB, 1993	782	Current and Closed OB/OD Areas
3	Yes		1	0 - 6"	Yes	1614059.00	2487726.34	UXB, 1993	783	Current and Closed OB/OD Areas
3	Yes		1	0 - 6"	Yes	1614019.91	2487667.80	UXB, 1993	784	Current and Closed OB/OD Areas
3	Yes		1	0 - 6"	Yes	1614076.91	2487652.78	UXB, 1993	785	Current and Closed OB/OD Areas
3	Yes		1	0 - 6"	Yes	1614141.32	2487641.88	UXB, 1993	786	Current and Closed OB/OD Areas
3	Yes		1	0 - 6"	Yes	1614220.92	2487640.64	UXB, 1993	787	Current and Closed OB/OD Areas

**Military Munitions Summary Table**  
**Parcel 3**  
**Fort Wingate Depot Activity**  
**Gallup, New Mexico**

Parcel No.	Removed	Item Description	Quantity	Depth (ft. BGS)	Mapped	Northing	Easting	Source	ID No.	Area Description
3	Yes		1	0 - 6"	Yes	1614263.05	2487619.29	UXB, 1993	788	Current and Closed OB/OD Areas
3	Yes		1	0 - 6"	Yes	1614387.23	2487530.52	UXB, 1993	789	Current and Closed OB/OD Areas
3	Yes		1	0 - 6"	Yes	1614435.98	2487498.57	UXB, 1993	790	Current and Closed OB/OD Areas
3	Yes		1	0 - 6"	Yes	1614292.27	2487536.29	UXB, 1993	791	Current and Closed OB/OD Areas
3	Yes		1	0 - 6"	Yes	1614334.53	2487512.10	UXB, 1993	792	Current and Closed OB/OD Areas
3	Yes		1	0 - 6"	Yes	1614381.78	2487481.98	UXB, 1993	793	Current and Closed OB/OD Areas
3	Yes		1	0 - 6"	Yes	1614386.85	2487420.65	UXB, 1993	794	Current and Closed OB/OD Areas
3	Yes		1	0 - 6"	Yes	1614313.63	2487459.57	UXB, 1993	795	Current and Closed OB/OD Areas
3	Yes		1	0 - 6"	Yes	1614203.66	2487505.41	UXB, 1993	796	Current and Closed OB/OD Areas
3	Yes		1	0 - 6"	Yes	1614047.82	2487549.70	UXB, 1993	797	Current and Closed OB/OD Areas
3	Yes		1	0 - 6"	Yes	1614157.24	2487462.65	UXB, 1993	798	Current and Closed OB/OD Areas
3	Yes		1	0 - 6"	Yes	1614060.50	2487498.17	UXB, 1993	799	Current and Closed OB/OD Areas
3	Yes		1	0 - 6"	Yes	1613955.63	2487535.71	UXB, 1993	800	Current and Closed OB/OD Areas
3	Yes		1	0 - 6"	Yes	1613910.13	2487547.44	UXB, 1993	801	Current and Closed OB/OD Areas
3	Yes		1	0 - 6"	Yes	1613953.49	2487487.31	UXB, 1993	802	Current and Closed OB/OD Areas
3	Yes		1	0 - 6"	Yes	1614080.97	2487441.77	UXB, 1993	803	Current and Closed OB/OD Areas
3	Yes		1	0 - 6"	Yes	1614131.06	2487422.67	UXB, 1993	804	Current and Closed OB/OD Areas
3	Yes		1	0 - 6"	Yes	1613946.82	2487348.28	UXB, 1993	805	Current and Closed OB/OD Areas
3	Yes		1	0 - 6"	Yes	1614572.88	2487174.07	UXB, 1993	806	Current and Closed OB/OD Areas
3	Yes		1	0 - 6"	Yes	1614446.38	2487175.61	UXB, 1993	807	Current and Closed OB/OD Areas
3	Yes		1	0 - 6"	Yes	1614338.76	2487189.35	UXB, 1993	808	Current and Closed OB/OD Areas
3	Yes		1	0 - 6"	Yes	1613489.60	2488260.07	UXB, 1993	809	Current and Closed OB/OD Areas
3	Yes		1	0 - 6"	Yes	1613632.47	2488198.16	UXB, 1993	810	Current and Closed OB/OD Areas
3	Yes		1	0 - 6"	Yes	1613801.20	2488054.52	UXB, 1993	811	Current and Closed OB/OD Areas
3	Yes		1	0 - 6"	Yes	1613525.67	2488096.40	UXB, 1993	812	Current and Closed OB/OD Areas
3	Yes		1	0 - 6"	Yes	1613473.72	2488114.95	UXB, 1993	813	Current and Closed OB/OD Areas
3	Yes		1	0 - 6"	Yes	1613485.05	2488051.05	UXB, 1993	814	Current and Closed OB/OD Areas
3	Yes		1	0 - 6"	Yes	1613620.32	2487989.75	UXB, 1993	815	Current and Closed OB/OD Areas
3	Yes		1	0 - 6"	Yes	1613458.88	2487978.40	UXB, 1993	816	Current and Closed OB/OD Areas
3	Yes		1	0 - 6"	Yes	1613357.59	2487891.09	UXB, 1993	817	Current and Closed OB/OD Areas
3	Yes		1	0 - 6"	Yes	1613463.36	2487844.12	UXB, 1993	818	Current and Closed OB/OD Areas
3	Yes		1	0 - 6"	Yes	1613465.66	2487705.48	UXB, 1993	819	Current and Closed OB/OD Areas
3	Yes		1	0 - 6"	Yes	1613554.36	2487669.60	UXB, 1993	820	Current and Closed OB/OD Areas
3	Yes		1	0 - 6"	Yes	1613642.90	2487637.51	UXB, 1993	821	Current and Closed OB/OD Areas
3	Yes		1	0 - 6"	Yes	1613391.07	2487668.11	UXB, 1993	822	Current and Closed OB/OD Areas
3	Yes		1	0 - 6"	Yes	1613546.11	2487609.58	UXB, 1993	823	Current and Closed OB/OD Areas
3	Yes		1	0 - 6"	Yes	1613697.93	2487549.01	UXB, 1993	824	Current and Closed OB/OD Areas
3	Yes		1	0 - 6"	Yes	1613812.11	2487515.20	UXB, 1993	825	Current and Closed OB/OD Areas
3	Yes		1	0 - 6"	Yes	1613725.10	2487491.01	UXB, 1993	826	Current and Closed OB/OD Areas
3	Yes		1	0 - 6"	Yes	1613786.41	2487399.48	UXB, 1993	827	Current and Closed OB/OD Areas
3	Yes		1	0 - 6"	Yes	1613840.49	2487375.81	UXB, 1993	828	Current and Closed OB/OD Areas
3	Yes		1	0 - 6"	Yes	1613514.44	2487435.83	UXB, 1993	829	Current and Closed OB/OD Areas
3	Yes		1	0 - 6"	Yes	1613424.48	2487478.75	UXB, 1993	830	Current and Closed OB/OD Areas
3	Yes		1	0 - 6"	Yes	1613407.70	2487418.83	UXB, 1993	831	Current and Closed OB/OD Areas
3	Yes		1	0 - 6"	Yes	1613467.07	2487393.02	UXB, 1993	832	Current and Closed OB/OD Areas
3	Yes		1	0 - 6"	Yes	1613540.96	2487360.28	UXB, 1993	833	Current and Closed OB/OD Areas
3	Yes		1	0 - 6"	Yes	1613671.36	2487312.98	UXB, 1993	834	Current and Closed OB/OD Areas
3	Yes		1	0 - 6"	Yes	1613775.87	2487219.08	UXB, 1993	835	Current and Closed OB/OD Areas
3	Yes		1	0 - 6"	Yes	1613854.16	2487129.24	UXB, 1993	836	Current and Closed OB/OD Areas

**Military Munitions Summary Table**  
**Parcel 3**  
**Fort Wingate Depot Activity**  
**Gallup, New Mexico**

Parcel No.	Removed	Item Description	Quantity	Depth (ft. BGS)	Mapped	Northing	Easting	Source	ID No.	Area Description
3	Yes		1	0 - 6"	Yes	1613579.90	2487185.37	UXB, 1993	837	Current and Closed OB/OD Areas
3	Yes		1	0 - 6"	Yes	1613501.58	2487103.33	UXB, 1993	838	Current and Closed OB/OD Areas
3	Yes		1	0 - 6"	Yes	1613365.02	2487139.95	UXB, 1993	839	Current and Closed OB/OD Areas
3	Yes		1	0 - 6"	Yes	1613350.87	2487084.87	UXB, 1993	840	Current and Closed OB/OD Areas
3	Yes		1	0 - 6"	Yes	1613153.02	2487514.18	UXB, 1993	841	Current and Closed OB/OD Areas
3	Yes		1	0 - 6"	Yes	1613027.23	2487693.80	UXB, 1993	842	Current and Closed OB/OD Areas
3	Yes		1	0 - 6"	Yes	1612965.92	2487752.66	UXB, 1993	843	Current and Closed OB/OD Areas
3	Yes		1	0 - 6"	Yes	1612892.66	2487771.22	UXB, 1993	844	Current and Closed OB/OD Areas
3	Yes		1	0 - 6"	Yes	1612898.79	2487815.06	UXB, 1993	845	Current and Closed OB/OD Areas
3	Yes		1	0 - 6"	Yes	1612694.30	2487932.03	UXB, 1993	846	Current and Closed OB/OD Areas
3	Yes		1	0 - 6"	Yes	1612556.28	2487926.44	UXB, 1993	847	Current and Closed OB/OD Areas
3	Yes		1	0 - 6"	Yes	1612439.55	2488050.58	UXB, 1993	848	Current and Closed OB/OD Areas
3	Yes		1	0 - 6"	Yes	1612581.62	2488007.10	UXB, 1993	849	Current and Closed OB/OD Areas
3	Yes		1	0 - 6"	Yes	1612738.52	2487970.90	UXB, 1993	850	Current and Closed OB/OD Areas
3	Yes		1	0 - 6"	Yes	1612847.91	2487949.19	UXB, 1993	851	Current and Closed OB/OD Areas
3	Yes		1	0 - 6"	Yes	1612971.43	2487983.03	UXB, 1993	852	Current and Closed OB/OD Areas
3	Yes		1	0 - 6"	Yes	1612853.63	2488066.88	UXB, 1993	853	Current and Closed OB/OD Areas
3	Yes		1	0 - 6"	Yes	1612679.31	2488090.00	UXB, 1993	854	Current and Closed OB/OD Areas
3	Yes		1	0 - 6"	Yes	1612578.37	2488113.50	UXB, 1993	855	Current and Closed OB/OD Areas
3	Yes		1	0 - 6"	Yes	1612502.45	2488138.57	UXB, 1993	856	Current and Closed OB/OD Areas
3	Yes		1	0 - 6"	Yes	1612475.77	2488250.10	UXB, 1993	857	Current and Closed OB/OD Areas
3	Yes		1	0 - 6"	Yes	1612766.74	2488180.02	UXB, 1993	858	Current and Closed OB/OD Areas
3	Yes		1	0 - 6"	Yes	1612894.78	2488175.70	UXB, 1993	859	Current and Closed OB/OD Areas
3	Yes		1	0 - 6"	Yes	1612824.66	2488241.28	UXB, 1993	860	Current and Closed OB/OD Areas
3	Yes		1	0 - 6"	Yes	1612654.20	2488316.65	UXB, 1993	861	Current and Closed OB/OD Areas
3	Yes		1	0 - 6"	Yes	1612782.51	2488295.30	UXB, 1993	862	Current and Closed OB/OD Areas
3	Yes		1	0 - 6"	Yes	1612951.86	2488277.64	UXB, 1993	863	Current and Closed OB/OD Areas
3	Yes		1	0 - 6"	Yes	1612757.09	2488356.69	UXB, 1993	864	Current and Closed OB/OD Areas
3	Yes		1	0 - 6"	Yes	1612903.59	2488330.92	UXB, 1993	865	Current and Closed OB/OD Areas
3	Yes		1	0 - 6"	Yes	1613042.56	2488325.66	UXB, 1993	866	Current and Closed OB/OD Areas
3	Yes		1	0 - 6"	Yes	1613109.32	2488314.86	UXB, 1993	867	Current and Closed OB/OD Areas
3	Yes		1	0 - 6"	Yes	1612842.49	2488395.95	UXB, 1993	868	Current and Closed OB/OD Areas
3	Yes		1	0 - 6"	Yes	1612935.32	2488449.27	UXB, 1993	869	Current and Closed OB/OD Areas
3	Yes		1	0 - 6"	Yes	1613050.54	2488434.92	UXB, 1993	870	Current and Closed OB/OD Areas
3	Yes		1	0 - 6"	Yes	1613170.21	2488405.61	UXB, 1993	871	Current and Closed OB/OD Areas
3	Yes		1	0 - 6"	Yes	1613098.26	2488469.69	UXB, 1993	872	Current and Closed OB/OD Areas
3	Yes		1	0 - 6"	Yes	1613000.93	2488540.23	UXB, 1993	873	Current and Closed OB/OD Areas
3	Yes		1	0 - 6"	Yes	1612864.10	2488539.90	UXB, 1993	874	Current and Closed OB/OD Areas
3	Yes		1	0 - 6"	Yes	1612711.88	2488545.05	UXB, 1993	875	Current and Closed OB/OD Areas
3	Yes		1	0 - 6"	Yes	1612504.44	2488588.97	UXB, 1993	876	Current and Closed OB/OD Areas
3	Yes		1	0 - 6"	Yes	1613327.53	2491601.32	UXB, 1993	877	Current and Closed OB/OD Areas
3	Yes		1	0 - 6"	Yes	1613331.98	2491533.99	UXB, 1993	878	Current and Closed OB/OD Areas
3	Yes		1	0 - 6"	Yes	1613328.91	2490966.07	UXB, 1993	879	Current and Closed OB/OD Areas
3	Yes		1	0 - 6"	Yes	1613509.78	2490694.89	UXB, 1993	880	Current and Closed OB/OD Areas
3	Yes		1	0 - 6"	Yes	1613608.23	2490806.57	UXB, 1993	881	Current and Closed OB/OD Areas
3	Yes		1	0 - 6"	Yes	1613807.47	2490891.03	UXB, 1993	882	Current and Closed OB/OD Areas
3	Yes		1	0 - 6"	Yes	1613947.68	2489549.76	UXB, 1993	883	Current and Closed OB/OD Areas
3	Yes		1	0 - 6"	Yes	1613932.12	2489830.23	UXB, 1993	884	Current and Closed OB/OD Areas
3	Yes		1	0 - 6"	Yes	1613930.22	2490028.26	UXB, 1993	885	Current and Closed OB/OD Areas

**Military Munitions Summary Table**  
**Parcel 3**  
**Fort Wingate Depot Activity**  
**Gallup, New Mexico**

Parcel No.	Removed	Item Description	Quantity	Depth (ft. BGS)	Mapped	Northing	Easting	Source	ID No.	Area Description
3	Yes		1	0 - 6"	Yes	1613969.70	2489998.49	UXB, 1993	886	Current and Closed OB/OD Areas
3	Yes		1	0 - 6"	Yes	1613968.03	2490083.50	UXB, 1993	887	Current and Closed OB/OD Areas
3	Yes		1	0 - 6"	Yes	1613979.75	2490155.57	UXB, 1993	888	Current and Closed OB/OD Areas
3	Yes		1	0 - 6"	Yes	1613933.06	2490233.04	UXB, 1993	889	Current and Closed OB/OD Areas
3	Yes		1	0 - 6"	Yes	1613989.11	2490606.25	UXB, 1993	890	Current and Closed OB/OD Areas
3	Yes		1	0 - 6"	Yes	1614048.63	2490226.73	UXB, 1993	891	Current and Closed OB/OD Areas
3	Yes		1	0 - 6"	Yes	1614020.72	2489863.44	UXB, 1993	892	Current and Closed OB/OD Areas
3	Yes		1	0 - 6"	Yes	1614011.59	2489729.14	UXB, 1993	893	Current and Closed OB/OD Areas
3	Yes		1	0 - 6"	Yes	1614084.66	2489419.85	UXB, 1993	894	Current and Closed OB/OD Areas
3	Yes		1	0 - 6"	Yes	1614101.91	2489912.51	UXB, 1993	895	Current and Closed OB/OD Areas
3	Yes		1	0 - 6"	Yes	1614134.03	2490227.95	UXB, 1993	896	Current and Closed OB/OD Areas
3	Yes		1	0 - 6"	Yes	1614131.41	2490483.76	UXB, 1993	897	Current and Closed OB/OD Areas
3	Yes		1	0 - 6"	Yes	1614158.13	2490845.69	UXB, 1993	898	Current and Closed OB/OD Areas
3	Yes		1	0 - 6"	Yes	1614283.54	2492159.26	UXB, 1993	899	Current and Closed OB/OD Areas
3	Yes		1	0 - 6"	Yes	1614264.27	2491110.43	UXB, 1993	900	Current and Closed OB/OD Areas
3	Yes		1	0 - 6"	Yes	1614220.11	2490127.86	UXB, 1993	901	Current and Closed OB/OD Areas
3	Yes		1	0 - 6"	Yes	1614218.66	2489908.21	UXB, 1993	902	Current and Closed OB/OD Areas
3	Yes		1	0 - 6"	Yes	1614173.53	2489861.68	UXB, 1993	903	Current and Closed OB/OD Areas
3	Yes		1	0 - 6"	Yes	1614217.15	2489407.93	UXB, 1993	904	Current and Closed OB/OD Areas
3	Yes		1	0 - 6"	Yes	1614369.70	2490238.31	UXB, 1993	905	Current and Closed OB/OD Areas
3	Yes		1	0 - 6"	Yes	1614391.85	2490485.67	UXB, 1993	906	Current and Closed OB/OD Areas
3	Yes		1	0 - 6"	Yes	1614407.30	2490691.11	UXB, 1993	907	Current and Closed OB/OD Areas
3	Yes		1	0 - 6"	Yes	1614409.17	2490829.57	UXB, 1993	908	Current and Closed OB/OD Areas
3	Yes		1	0 - 6"	Yes	1614422.94	2490977.75	UXB, 1993	909	Current and Closed OB/OD Areas
3	Yes		1	0 - 6"	Yes	1614427.99	2491149.51	UXB, 1993	910	Current and Closed OB/OD Areas
3	Yes		1	0 - 6"	Yes	1614434.18	2491327.18	UXB, 1993	911	Current and Closed OB/OD Areas
3	Yes		1	0 - 6"	Yes	1614530.43	2491517.35	UXB, 1993	912	Current and Closed OB/OD Areas
3	Yes		1	0 - 6"	Yes	1614480.25	2490773.52	UXB, 1993	913	Current and Closed OB/OD Areas
3	Yes		1	0 - 6"	Yes	1614448.85	2490210.61	UXB, 1993	914	Current and Closed OB/OD Areas
3	Yes		1	0 - 6"	Yes	1614428.11	2490137.42	UXB, 1993	915	Current and Closed OB/OD Areas
3	Yes		1	0 - 6"	Yes	1614417.37	2489940.03	UXB, 1993	916	Current and Closed OB/OD Areas
3	Yes		1	0 - 6"	Yes	1614413.31	2489832.63	UXB, 1993	917	Current and Closed OB/OD Areas
3	Yes		1	0 - 6"	Yes	1614424.54	2489752.67	UXB, 1993	918	Current and Closed OB/OD Areas
3	Yes		1	0 - 6"	Yes	1614435.05	2489348.51	UXB, 1993	919	Current and Closed OB/OD Areas
3	Yes		1	0 - 6"	Yes	1614513.80	2489686.52	UXB, 1993	920	Current and Closed OB/OD Areas
3	Yes		1	0 - 6"	Yes	1614526.12	2489854.76	UXB, 1993	921	Current and Closed OB/OD Areas
3	Yes		1	0 - 6"	Yes	1614517.83	2489986.85	UXB, 1993	922	Current and Closed OB/OD Areas
3	Yes		1	0 - 6"	Yes	1614528.70	2490127.09	UXB, 1993	923	Current and Closed OB/OD Areas
3	Yes		1	0 - 6"	Yes	1614546.90	2490496.37	UXB, 1993	924	Current and Closed OB/OD Areas
3	Yes		1	0 - 6"	Yes	1614570.85	2490696.40	UXB, 1993	925	Current and Closed OB/OD Areas
3	Yes		1	0 - 6"	Yes	1614601.23	2491293.03	UXB, 1993	926	Current and Closed OB/OD Areas
3	Yes		1	0 - 6"	Yes	1614668.95	2491122.48	UXB, 1993	927	Current and Closed OB/OD Areas
3	Yes		1	0 - 6"	Yes	1614645.85	2490616.52	UXB, 1993	928	Current and Closed OB/OD Areas
3	Yes		1	0 - 6"	Yes	1614579.78	2489701.66	UXB, 1993	929	Current and Closed OB/OD Areas
3	Yes		1	0 - 6"	Yes	1614706.63	2489325.02	UXB, 1993	930	Current and Closed OB/OD Areas
3	Yes		1	0 - 6"	Yes	1614651.17	2489334.46	UXB, 1993	931	Current and Closed OB/OD Areas
3	Yes		1	0 - 6"	Yes	1614633.52	2489398.50	UXB, 1993	932	Current and Closed OB/OD Areas
3	Yes		1	0 - 6"	Yes	1614674.91	2489407.81	UXB, 1993	933	Current and Closed OB/OD Areas
3	Yes		1	0 - 6"	Yes	1614689.71	2489808.74	UXB, 1993	934	Current and Closed OB/OD Areas

**Military Munitions Summary Table**  
**Parcel 3**  
**Fort Wingate Depot Activity**  
**Gallup, New Mexico**

Parcel No.	Removed	Item Description	Quantity	Depth (ft. BGS)	Mapped	Northing	Easting	Source	ID No.	Area Description
3	Yes		1	0 - 6"	Yes	1614690.13	2489918.55	UXB, 1993	935	Current and Closed OB/OD Areas
3	Yes		1	0 - 6"	Yes	1614740.93	2490708.53	UXB, 1993	936	Current and Closed OB/OD Areas
3	Yes		1	0 - 6"	Yes	1614776.64	2491502.93	UXB, 1993	937	Current and Closed OB/OD Areas
3	Yes		1	0 - 6"	Yes	1614832.23	2491148.55	UXB, 1993	938	Current and Closed OB/OD Areas
3	Yes		1	0 - 6"	Yes	1614798.47	2490581.62	UXB, 1993	939	Current and Closed OB/OD Areas
3	Yes		1	0 - 6"	Yes	1614766.78	2490088.86	UXB, 1993	940	Current and Closed OB/OD Areas
3	Yes		1	0 - 6"	Yes	1614761.90	2489998.95	UXB, 1993	941	Current and Closed OB/OD Areas
3	Yes		1	0 - 6"	Yes	1614762.63	2489893.11	UXB, 1993	942	Current and Closed OB/OD Areas
3	Yes		1	0 - 6"	Yes	1614750.25	2489777.48	UXB, 1993	943	Current and Closed OB/OD Areas
3	Yes		1	0 - 6"	Yes	1614745.30	2489693.42	UXB, 1993	944	Current and Closed OB/OD Areas
3	Yes		1	0 - 6"	Yes	1614908.56	2491631.30	UXB, 1993	945	Current and Closed OB/OD Areas
3	Yes		1	0 - 6"	Yes	1614896.83	2491368.89	UXB, 1993	946	Current and Closed OB/OD Areas
3	Yes		1	0 - 6"	Yes	1614869.08	2490897.12	UXB, 1993	947	Current and Closed OB/OD Areas
3	Yes		1	0 - 6"	Yes	1614860.98	2490633.60	UXB, 1993	948	Current and Closed OB/OD Areas
3	Yes		1	0 - 6"	Yes	1614852.73	2490381.12	UXB, 1993	949	Current and Closed OB/OD Areas
3	Yes		1	0 - 6"	Yes	1614830.46	2490095.43	UXB, 1993	950	Current and Closed OB/OD Areas
3	Yes		1	0 - 6"	Yes	1614826.52	2489978.94	UXB, 1993	951	Current and Closed OB/OD Areas
3	Yes		1	0 - 6"	Yes	1614814.24	2489711.96	UXB, 1993	952	Current and Closed OB/OD Areas
3	Yes		1	0 - 6"	Yes	1614808.37	2489605.12	UXB, 1993	953	Current and Closed OB/OD Areas
3	Yes		1	0 - 6"	Yes	1614876.66	2489914.00	UXB, 1993	954	Current and Closed OB/OD Areas
3	Yes		1	0 - 6"	Yes	1614870.20	2489758.41	UXB, 1993	955	Current and Closed OB/OD Areas
3	Yes		1	0 - 6"	Yes	1614861.53	2489634.53	UXB, 1993	956	Current and Closed OB/OD Areas
3	Yes		1	0 - 6"	Yes	1614866.31	2489064.42	UXB, 1993	957	Current and Closed OB/OD Areas
3	Yes		1	0 - 6"	Yes	1614956.13	2489765.50	UXB, 1993	958	Current and Closed OB/OD Areas
3	Yes		1	0 - 6"	Yes	1614982.59	2489718.16	UXB, 1993	959	Current and Closed OB/OD Areas
3	Yes		1	0 - 6"	Yes	1614941.14	2489665.97	UXB, 1993	960	Current and Closed OB/OD Areas
3	Yes		1	0 - 6"	Yes	1614973.96	2489639.10	UXB, 1993	961	Current and Closed OB/OD Areas
3	Yes		1	0 - 6"	Yes	1614943.09	2489606.96	UXB, 1993	962	Current and Closed OB/OD Areas
3	Yes		1	0 - 6"	Yes	1614976.33	2489594.40	UXB, 1993	963	Current and Closed OB/OD Areas
3	Yes		1	0 - 6"	Yes	1614959.53	2489542.86	UXB, 1993	964	Current and Closed OB/OD Areas
3	Yes		1	0 - 6"	Yes	1614936.64	2489498.14	UXB, 1993	965	Current and Closed OB/OD Areas
3	Yes		1	0 - 6"	Yes	1614923.43	2489448.08	UXB, 1993	966	Current and Closed OB/OD Areas
3	Yes		1	0 - 6"	Yes	1614956.45	2489405.63	UXB, 1993	967	Current and Closed OB/OD Areas
3	Yes		1	0 - 6"	Yes	1615099.41	2490280.98	UXB, 1993	968	Current and Closed OB/OD Areas
3	Yes		1	0 - 6"	Yes	1615095.87	2490180.10	UXB, 1993	969	Current and Closed OB/OD Areas
3	Yes		1	0 - 6"	Yes	1615096.74	2490111.29	UXB, 1993	970	Current and Closed OB/OD Areas
3	Yes		1	0 - 6"	Yes	1615090.73	2490015.48	UXB, 1993	971	Current and Closed OB/OD Areas
3	Yes		1	0 - 6"	Yes	1615085.43	2489910.62	UXB, 1993	972	Current and Closed OB/OD Areas
3	Yes		1	0 - 6"	Yes	1615088.44	2489814.63	UXB, 1993	973	Current and Closed OB/OD Areas
3	Yes		1	0 - 6"	Yes	1615180.31	2489923.37	UXB, 1993	974	Current and Closed OB/OD Areas
3	Yes		1	0 - 6"	Yes	1615174.15	2490078.31	UXB, 1993	975	Current and Closed OB/OD Areas
3	Yes		1	0 - 6"	Yes	1615181.45	2490215.11	UXB, 1993	976	Current and Closed OB/OD Areas
3	Yes		1	0 - 6"	Yes	1615188.04	2490312.24	UXB, 1993	977	Current and Closed OB/OD Areas
3	Yes		1	0 - 6"	Yes	1615179.23	2490439.11	UXB, 1993	978	Current and Closed OB/OD Areas
3	Yes		1	0 - 6"	Yes	1615203.55	2490991.25	UXB, 1993	979	Current and Closed OB/OD Areas
3	Yes		1	0 - 6"	Yes	1615270.02	2490346.41	UXB, 1993	980	Current and Closed OB/OD Areas
3	Yes		1	0 - 6"	Yes	1615272.05	2490232.83	UXB, 1993	981	Current and Closed OB/OD Areas
3	Yes		1	0 - 6"	Yes	1615263.13	2490129.73	UXB, 1993	982	Current and Closed OB/OD Areas
3	Yes		1	0 - 6"	Yes	1615358.37	2490352.32	UXB, 1993	983	Current and Closed OB/OD Areas



**Military Munitions Summary Table**  
**Parcel 3**  
**Fort Wingate Depot Activity**  
**Gallup, New Mexico**

Parcel No.	Removed	Item Description	Quantity	Depth (ft. BGS)	Mapped	Northing	Easting	Source	ID No.	Area Description
3	Yes		1	0 - 6"	Yes	1615333.96	2489854.74	UXB, 1993	984	Current and Closed OB/OD Areas
3	Yes		1	0 - 6"	Yes	1615424.90	2490084.91	UXB, 1993	985	Current and Closed OB/OD Areas
3	Yes		1	0 - 6"	Yes	1615435.39	2490206.94	UXB, 1993	986	Current and Closed OB/OD Areas
3	Yes		1	0 - 6"	Yes	1615489.53	2490254.59	UXB, 1993	987	Current and Closed OB/OD Areas
3	Yes		1	0 - 6"	Yes	1615487.53	2489984.24	UXB, 1993	988	Current and Closed OB/OD Areas
3	Yes		1	0 - 6"	Yes	1615307.00	2489559.71	UXB, 1993	989	Current and Closed OB/OD Areas
3	Yes		1	0 - 6"	Yes	1615015.57	2489391.83	UXB, 1993	990	Current and Closed OB/OD Areas
3	Yes		1	0 - 6"	Yes	1614933.55	2489075.08	UXB, 1993	991	Current and Closed OB/OD Areas
3	Yes		1	0 - 6"	Yes	1615171.25	2488971.86	UXB, 1993	992	Current and Closed OB/OD Areas
3	Yes		1	0 - 6"	Yes	1615086.03	2489003.79	UXB, 1993	993	Current and Closed OB/OD Areas
3	Yes		1	0 - 6"	Yes	1615013.15	2489011.03	UXB, 1993	994	Current and Closed OB/OD Areas
3	Yes		1	0 - 6"	Yes	1615033.69	2488908.81	UXB, 1993	995	Current and Closed OB/OD Areas
3	Yes		1	0 - 6"	Yes	1615122.82	2488900.47	UXB, 1993	996	Current and Closed OB/OD Areas
3	Yes		1	0 - 6"	Yes	1615209.64	2488884.87	UXB, 1993	997	Current and Closed OB/OD Areas
3	Yes		1	0 - 6"	Yes	1615288.39	2488888.99	UXB, 1993	998	Current and Closed OB/OD Areas
3	Yes		1	0 - 6"	Yes	1615454.60	2488921.71	UXB, 1993	999	Current and Closed OB/OD Areas
3	Yes		1	0 - 6"	Yes	1615446.18	2489112.25	UXB, 1993	1000	Current and Closed OB/OD Areas
3	Yes		1	0 - 6"	Yes	1615450.80	2489175.51	UXB, 1993	1001	Current and Closed OB/OD Areas
3	Yes		1	0 - 6"	Yes	1615492.05	2489816.23	UXB, 1993	1002	Current and Closed OB/OD Areas
3	Yes		1	0 - 6"	Yes	1615520.02	2490508.23	UXB, 1993	1003	Current and Closed OB/OD Areas
3	Yes		1	0 - 6"	Yes	1615525.24	2490906.07	UXB, 1993	1004	Current and Closed OB/OD Areas
3	Yes		1	0 - 6"	Yes	1615507.36	2491035.70	UXB, 1993	1005	Current and Closed OB/OD Areas
3	Yes		1	0 - 6"	Yes	1615531.68	2491110.38	UXB, 1993	1006	Current and Closed OB/OD Areas
3	Yes		1	0 - 6"	Yes	1615608.94	2490612.27	UXB, 1993	1007	Current and Closed OB/OD Areas
3	Yes		1	0 - 6"	Yes	1615572.61	2489962.70	UXB, 1993	1008	Current and Closed OB/OD Areas
3	Yes		1	0 - 6"	Yes	1615577.83	2489882.43	UXB, 1993	1009	Current and Closed OB/OD Areas
3	Yes		1	0 - 6"	Yes	1615570.44	2489800.84	UXB, 1993	1010	Current and Closed OB/OD Areas
3	Yes		1	0 - 6"	Yes	1615556.34	2488867.26	UXB, 1993	1011	Current and Closed OB/OD Areas
3	Yes		1	0 - 6"	Yes	1615562.39	2488959.82	UXB, 1993	1012	Current and Closed OB/OD Areas
3	Yes		1	0 - 6"	Yes	1615555.91	2489044.58	UXB, 1993	1013	Current and Closed OB/OD Areas
3	Yes		1	0 - 6"	Yes	1615544.13	2489119.97	UXB, 1993	1014	Current and Closed OB/OD Areas
3	Yes		1	0 - 6"	Yes	1615622.79	2489226.72	UXB, 1993	1015	Current and Closed OB/OD Areas
3	Yes		1	0 - 6"	Yes	1615651.76	2489171.06	UXB, 1993	1016	Current and Closed OB/OD Areas
3	Yes		1	0 - 6"	Yes	1615647.15	2489107.16	UXB, 1993	1017	Current and Closed OB/OD Areas
3	Yes		1	0 - 6"	Yes	1615643.48	2489016.67	UXB, 1993	1018	Current and Closed OB/OD Areas
3	Yes		1	0 - 6"	Yes	1615646.30	2488936.27	UXB, 1993	1019	Current and Closed OB/OD Areas
3	Yes		1	0 - 6"	Yes	1615715.30	2488950.27	UXB, 1993	1020	Current and Closed OB/OD Areas
3	Yes		1	0 - 6"	Yes	1615723.78	2489136.50	UXB, 1993	1021	Current and Closed OB/OD Areas
3	Yes		1	0 - 6"	Yes	1615754.79	2489730.57	UXB, 1993	1022	Current and Closed OB/OD Areas
3	Yes		1	0 - 6"	Yes	1615826.49	2491296.63	UXB, 1993	1023	Current and Closed OB/OD Areas
3	Yes		1	0 - 6"	Yes	1615802.33	2491352.53	UXB, 1993	1024	Current and Closed OB/OD Areas
3	Yes		1	0 - 6"	Yes	1615852.23	2491354.49	UXB, 1993	1025	Current and Closed OB/OD Areas
3	Yes		1	0 - 6"	Yes	1615802.41	2491393.47	UXB, 1993	1026	Current and Closed OB/OD Areas
3	Yes		1	0 - 6"	Yes	1615863.50	2490029.87	UXB, 1993	1027	Current and Closed OB/OD Areas
3	Yes		1	0 - 6"	Yes	1615867.96	2489819.63	UXB, 1993	1028	Current and Closed OB/OD Areas
3	Yes		1	0 - 6"	Yes	1615832.89	2489022.67	UXB, 1993	1029	Current and Closed OB/OD Areas
3	Yes		1	0 - 6"	Yes	1615987.86	2490758.74	UXB, 1993	1030	Current and Closed OB/OD Areas
3	Yes		1	0 - 6"	Yes	1615991.61	2491272.78	UXB, 1993	1031	Current and Closed OB/OD Areas
3	Yes		1	0 - 6"	Yes	1616001.08	2491380.46	UXB, 1993	1032	Current and Closed OB/OD Areas

**Military Munitions Summary Table**  
**Parcel 3**  
**Fort Wingate Depot Activity**  
**Gallup, New Mexico**

Parcel No.	Removed	Item Description	Quantity	Depth (ft. BGS)	Mapped	Northing	Easting	Source	ID No.	Area Description
3	Yes		1	0 - 6"	Yes	1616011.14	2491584.31	UXB, 1993	1033	Current and Closed OB/OD Areas
3	Yes		1	0 - 6"	Yes	1616080.20	2491498.27	UXB, 1993	1034	Current and Closed OB/OD Areas
3	Yes		1	0 - 6"	Yes	1616072.37	2490973.63	UXB, 1993	1035	Current and Closed OB/OD Areas
3	Yes		1	0 - 6"	Yes	1616051.05	2490326.80	UXB, 1993	1036	Current and Closed OB/OD Areas
3	Yes		1	0 - 6"	Yes	1616020.66	2489730.81	UXB, 1993	1037	Current and Closed OB/OD Areas
3	Yes		1	0 - 6"	Yes	1616026.36	2489612.88	UXB, 1993	1038	Current and Closed OB/OD Areas
3	Yes		1	0 - 6"	Yes	1616039.27	2489590.82	UXB, 1993	1039	Current and Closed OB/OD Areas
3	Yes		1	0 - 6"	Yes	1615914.49	2489229.61	UXB, 1993	1040	Current and Closed OB/OD Areas
3	Yes		1	0 - 6"	Yes	1615940.95	2489182.92	UXB, 1993	1041	Current and Closed OB/OD Areas
3	Yes		1	0 - 6"	Yes	1616093.68	2488996.02	UXB, 1993	1042	Current and Closed OB/OD Areas
3	Yes		1	0 - 6"	Yes	1616097.07	2489156.65	UXB, 1993	1043	Current and Closed OB/OD Areas
3	Yes		1	0 - 6"	Yes	1616100.26	2489238.02	UXB, 1993	1044	Current and Closed OB/OD Areas
3	Yes		1	0 - 6"	Yes	1616119.24	2489641.12	UXB, 1993	1045	Current and Closed OB/OD Areas
3	Yes		1	0 - 6"	Yes	1616129.08	2490148.98	UXB, 1993	1046	Current and Closed OB/OD Areas
3	Yes		1	0 - 6"	Yes	1616130.04	2490215.94	UXB, 1993	1047	Current and Closed OB/OD Areas
3	Yes		1	0 - 6"	Yes	1616168.06	2491209.24	UXB, 1993	1048	Current and Closed OB/OD Areas
3	Yes		1	0 - 6"	Yes	1616166.58	2491374.16	UXB, 1993	1049	Current and Closed OB/OD Areas
3	Yes		1	0 - 6"	Yes	1616254.05	2491163.06	UXB, 1993	1050	Current and Closed OB/OD Areas
3	Yes		1	0 - 6"	Yes	1616245.38	2490992.41	UXB, 1993	1051	Current and Closed OB/OD Areas
3	Yes		1	0 - 6"	Yes	1616230.15	2490720.73	UXB, 1993	1052	Current and Closed OB/OD Areas
3	Yes		1	0 - 6"	Yes	1616303.95	2489971.68	UXB, 1993	1053	Current and Closed OB/OD Areas
3	Yes		1	0 - 6"	Yes	1616295.73	2489860.17	UXB, 1993	1054	Current and Closed OB/OD Areas
3	Yes		1	0 - 6"	Yes	1616292.01	2489773.57	UXB, 1993	1055	Current and Closed OB/OD Areas
3	Yes		1	0 - 6"	Yes	1616289.71	2489670.16	UXB, 1993	1056	Current and Closed OB/OD Areas
3	Yes		1	0 - 6"	Yes	1616271.30	2489220.97	UXB, 1993	1057	Current and Closed OB/OD Areas
3	Yes		1	0 - 6"	Yes	1616264.70	2489124.48	UXB, 1993	1058	Current and Closed OB/OD Areas
3	Yes		1	0 - 6"	Yes	1616270.26	2489017.59	UXB, 1993	1059	Current and Closed OB/OD Areas
3	Yes		1	0 - 6"	Yes	1616435.76	2489106.78	UXB, 1993	1060	Current and Closed OB/OD Areas
3	Yes		1	0 - 6"	Yes	1616438.71	2489206.33	UXB, 1993	1061	Current and Closed OB/OD Areas
3	Yes		1	0 - 6"	Yes	1616442.65	2489323.47	UXB, 1993	1062	Current and Closed OB/OD Areas
3	Yes		1	0 - 6"	Yes	1616436.93	2489538.84	UXB, 1993	1063	Current and Closed OB/OD Areas
3	Yes		1	0 - 6"	Yes	1616447.34	2489667.36	UXB, 1993	1064	Current and Closed OB/OD Areas
3	Yes		1	0 - 6"	Yes	1616450.72	2489781.21	UXB, 1993	1065	Current and Closed OB/OD Areas
3	Yes		1	0 - 6"	Yes	1616458.00	2489871.89	UXB, 1993	1066	Current and Closed OB/OD Areas
3	Yes		1	0 - 6"	Yes	1616450.29	2489958.54	UXB, 1993	1067	Current and Closed OB/OD Areas
3	Yes		1	0 - 6"	Yes	1616467.11	2490055.56	UXB, 1993	1068	Current and Closed OB/OD Areas
3	Yes		1	0 - 6"	Yes	1616463.77	2490130.09	UXB, 1993	1069	Current and Closed OB/OD Areas
3	Yes		1	0 - 6"	Yes	1616462.78	2490208.64	UXB, 1993	1070	Current and Closed OB/OD Areas
3	Yes		1	0 - 6"	Yes	1616607.41	2491620.01	UXB, 1993	1071	Current and Closed OB/OD Areas
3	Yes		1	0 - 6"	Yes	1616555.05	2489616.47	UXB, 1993	1072	Current and Closed OB/OD Areas
3	Yes		1	0 - 6"	Yes	1616551.16	2489496.08	UXB, 1993	1073	Current and Closed OB/OD Areas
3	Yes		1	0 - 6"	Yes	1616541.49	2489355.91	UXB, 1993	1074	Current and Closed OB/OD Areas
3	Yes		1	0 - 6"	Yes	1616540.01	2489187.59	UXB, 1993	1075	Current and Closed OB/OD Areas
3	Yes		1	0 - 6"	Yes	1616528.74	2489079.16	UXB, 1993	1076	Current and Closed OB/OD Areas
3	Yes		1	0 - 6"	Yes	1616527.00	2488978.38	UXB, 1993	1077	Current and Closed OB/OD Areas
3	Yes		1	0 - 6"	Yes	1616588.98	2488929.00	UXB, 1993	1078	Current and Closed OB/OD Areas
3	Yes		1	0 - 6"	Yes	1616600.72	2488999.77	UXB, 1993	1079	Current and Closed OB/OD Areas
3	Yes		1	0 - 6"	Yes	1616623.93	2489115.32	UXB, 1993	1080	Current and Closed OB/OD Areas
3	Yes		1	0 - 6"	Yes	1616616.52	2489273.43	UXB, 1993	1081	Current and Closed OB/OD Areas

**Military Munitions Summary Table**  
**Parcel 3**  
**Fort Wingate Depot Activity**  
**Gallup, New Mexico**

Parcel No.	Removed	Item Description	Quantity	Depth (ft. BGS)	Mapped	Northing	Easting	Source	ID No.	Area Description
3	Yes		1	0 - 6"	Yes	1616640.20	2489399.40	UXB, 1993	1082	Current and Closed OB/OD Areas
3	Yes		1	0 - 6"	Yes	1616619.40	2489617.88	UXB, 1993	1083	Current and Closed OB/OD Areas
3	Yes		1	0 - 6"	Yes	1616631.77	2489781.58	UXB, 1993	1084	Current and Closed OB/OD Areas
3	Yes		1	0 - 6"	Yes	1616634.51	2489898.65	UXB, 1993	1085	Current and Closed OB/OD Areas
3	Yes		1	0 - 6"	Yes	1616663.72	2490015.16	UXB, 1993	1086	Current and Closed OB/OD Areas
3	Yes		1	0 - 6"	Yes	1616632.24	2490173.97	UXB, 1993	1087	Current and Closed OB/OD Areas
3	Yes		1	0 - 6"	Yes	1616652.66	2490271.83	UXB, 1993	1088	Current and Closed OB/OD Areas
3	Yes		1	0 - 6"	Yes	1616656.58	2490438.33	UXB, 1993	1089	Current and Closed OB/OD Areas
3	Yes		1	0 - 6"	Yes	1616640.25	2490493.35	UXB, 1993	1090	Current and Closed OB/OD Areas
3	Yes		1	0 - 6"	Yes	1616672.58	2490791.91	UXB, 1993	1091	Current and Closed OB/OD Areas
3	Yes		1	0 - 6"	Yes	1616695.17	2491481.68	UXB, 1993	1092	Current and Closed OB/OD Areas
2	Yes		1	0 - 6"	Yes	1616767.76	2491878.49	UXB, 1993	1093	Current and Closed OB/OD Areas
3	Yes		1	0 - 6"	Yes	1616724.89	2490602.36	UXB, 1993	1094	Current and Closed OB/OD Areas
3	Yes		1	0 - 6"	Yes	1616747.91	2490541.85	UXB, 1993	1095	Current and Closed OB/OD Areas
3	Yes		1	0 - 6"	Yes	1616717.01	2490512.30	UXB, 1993	1096	Current and Closed OB/OD Areas
3	Yes		1	0 - 6"	Yes	1616756.94	2490446.18	UXB, 1993	1097	Current and Closed OB/OD Areas
3	Yes		1	0 - 6"	Yes	1616712.65	2490428.27	UXB, 1993	1098	Current and Closed OB/OD Areas
3	Yes		1	0 - 6"	Yes	1616710.12	2489770.08	UXB, 1993	1099	Current and Closed OB/OD Areas
3	Yes		1	0 - 6"	Yes	1616715.31	2489644.33	UXB, 1993	1100	Current and Closed OB/OD Areas
3	Yes		1	0 - 6"	Yes	1616691.36	2489492.37	UXB, 1993	1101	Current and Closed OB/OD Areas
3	Yes		1	0 - 6"	Yes	1616723.22	2489445.96	UXB, 1993	1102	Current and Closed OB/OD Areas
3	Yes		1	0 - 6"	Yes	1616801.36	2490262.06	UXB, 1993	1103	Current and Closed OB/OD Areas
3	Yes		1	0 - 6"	Yes	1616831.57	2490203.87	UXB, 1993	1104	Current and Closed OB/OD Areas
3	Yes		1	0 - 6"	Yes	1616776.45	2490186.70	UXB, 1993	1105	Current and Closed OB/OD Areas
3	Yes		1	0 - 6"	Yes	1616802.46	2490127.64	UXB, 1993	1106	Current and Closed OB/OD Areas
3	Yes		1	0 - 6"	Yes	1616909.27	2491294.08	UXB, 1993	1107	Current and Closed OB/OD Areas
3	Yes		1	0 - 6"	Yes	1617060.27	2491435.79	UXB, 1993	1108	Current and Closed OB/OD Areas
3	Yes		1	0 - 6"	Yes	1617009.87	2489992.97	UXB, 1993	1109	Current and Closed OB/OD Areas
3	Yes		1	0 - 6"	Yes	1617078.67	2489211.18	UXB, 1993	1110	Current and Closed OB/OD Areas
3	Yes		1	0 - 6"	Yes	1617075.67	2489353.94	UXB, 1993	1111	Current and Closed OB/OD Areas
3	Yes		1	0 - 6"	Yes	1617098.67	2490059.32	UXB, 1993	1112	Current and Closed OB/OD Areas
3	Yes		1	0 - 6"	Yes	1617088.87	2490168.59	UXB, 1993	1113	Current and Closed OB/OD Areas
3	Yes		1	0 - 6"	Yes	1617286.12	2490888.28	UXB, 1993	1114	Current and Closed OB/OD Areas
3	Yes		1	0 - 6"	Yes	1617254.69	2490327.32	UXB, 1993	1115	Current and Closed OB/OD Areas
3	Yes		1	0 - 6"	Yes	1617248.83	2489742.36	UXB, 1993	1116	Current and Closed OB/OD Areas
3	Yes		1	0 - 6"	Yes	1617239.87	2489546.36	UXB, 1993	1117	Current and Closed OB/OD Areas
3	Yes		1	0 - 6"	Yes	1617246.81	2489282.33	UXB, 1993	1118	Current and Closed OB/OD Areas
3	Yes		1	0 - 6"	Yes	1617328.96	2489493.84	UXB, 1993	1119	Current and Closed OB/OD Areas
3	Yes		1	0 - 6"	Yes	1617334.74	2489894.31	UXB, 1993	1120	Current and Closed OB/OD Areas
3	Yes		1	0 - 6"	Yes	1617349.37	2490212.73	UXB, 1993	1121	Current and Closed OB/OD Areas
3	Yes		1	0 - 6"	Yes	1617343.10	2490471.60	UXB, 1993	1122	Current and Closed OB/OD Areas
3	Yes		1	0 - 6"	Yes	1617426.80	2490513.00	UXB, 1993	1123	Current and Closed OB/OD Areas
3	Yes		1	0 - 6"	Yes	1617396.13	2489270.64	UXB, 1993	1124	Current and Closed OB/OD Areas
3	Yes		1	0 - 6"	Yes	1617396.99	2489011.49	UXB, 1993	1125	Current and Closed OB/OD Areas
3	Yes		1	0 - 6"	Yes	1617479.00	2489282.11	UXB, 1993	1126	Current and Closed OB/OD Areas
3	Yes		1	0 - 6"	Yes	1617613.60	2489197.55	UXB, 1993	1127	Current and Closed OB/OD Areas
3	Yes		1	0 - 6"	Yes	1617705.41	2489167.92	UXB, 1993	1128	Current and Closed OB/OD Areas
3	Yes		1	0 - 6"	Yes	1617770.55	2489106.36	UXB, 1993	1129	Current and Closed OB/OD Areas
3	Yes		1	0 - 6"	Yes	1617777.88	2489240.56	UXB, 1993	1130	Current and Closed OB/OD Areas

**Military Munitions Summary Table**  
**Parcel 3**  
**Fort Wingate Depot Activity**  
**Gallup, New Mexico**

Parcel No.	Removed	Item Description	Quantity	Depth (ft. BGS)	Mapped	Northing	Easting	Source	ID No.	Area Description
3	Yes		1	0 - 6"	Yes	1617784.34	2489396.16	UXB, 1993	1131	Current and Closed OB/OD Areas
3	Yes		1	0 - 6"	Yes	1618032.29	2489195.39	UXB, 1993	1132	Current and Closed OB/OD Areas
3	Yes		1	0 - 6"	Yes	1618663.63	2489598.00	UXB, 1993	1133	Current and Closed OB/OD Areas
3	Yes		1	0 - 6"	Yes	1612713.24	2491420.47	UXB, 1993	1134	Current and Closed OB/OD Areas
3	Yes		1	0 - 6"	Yes	1612708.68	2490732.29	UXB, 1993	1135	Current and Closed OB/OD Areas
3	Yes		1	0 - 6"	Yes	1612697.47	2490667.39	UXB, 1993	1136	Current and Closed OB/OD Areas
3	Yes		1	0 - 6"	Yes	1612610.08	2490584.87	UXB, 1993	1137	Current and Closed OB/OD Areas
3	Yes		1	0 - 6"	Yes	1612622.17	2490532.23	UXB, 1993	1138	Current and Closed OB/OD Areas
3	Yes		1	0 - 6"	Yes	1612648.44	2490404.98	UXB, 1993	1139	Current and Closed OB/OD Areas
3	Yes		1	0 - 6"	Yes	1612492.30	2490337.06	UXB, 1993	1140	Current and Closed OB/OD Areas
3	Yes		1	0 - 6"	Yes	1612535.33	2490263.95	UXB, 1993	1141	Current and Closed OB/OD Areas
3	Yes		1	0 - 6"	Yes	1612396.62	2490101.45	UXB, 1993	1142	Current and Closed OB/OD Areas
3	Yes		1	0 - 6"	Yes	1612063.88	2491254.67	UXB, 1993	1143	Current and Closed OB/OD Areas
3	Yes		1	0 - 6"	Yes	1612194.43	2490489.10	UXB, 1993	1144	Current and Closed OB/OD Areas
3	Yes		1	0 - 6"	Yes	1612123.67	2490519.18	UXB, 1993	1145	Current and Closed OB/OD Areas
3	Yes		1	0 - 6"	Yes	1611856.74	2490746.89	UXB, 1993	1146	Current and Closed OB/OD Areas
3	Yes		1	0 - 6"	Yes	1611793.11	2490831.27	UXB, 1993	1147	Current and Closed OB/OD Areas
3	Yes		1	0 - 6"	Yes	1611702.25	2489449.34	UXB, 1993	1148	Current and Closed OB/OD Areas
3	Yes		1	0 - 6"	Yes	1611783.99	2489406.84	UXB, 1993	1149	Current and Closed OB/OD Areas
3	Yes		1	0 - 6"	Yes	1611916.78	2489466.40	UXB, 1993	1150	Current and Closed OB/OD Areas
3	Yes		1	0 - 6"	Yes	1611896.53	2489354.90	UXB, 1993	1151	Current and Closed OB/OD Areas
3	Yes		1	0 - 6"	Yes	1611796.49	2489322.39	UXB, 1993	1152	Current and Closed OB/OD Areas
3	Yes		1	0 - 6"	Yes	1611674.95	2489324.49	UXB, 1993	1153	Current and Closed OB/OD Areas
3	Yes		1	0 - 6"	Yes	1611660.28	2489247.72	UXB, 1993	1154	Current and Closed OB/OD Areas
3	Yes		1	0 - 6"	Yes	1611708.52	2489238.54	UXB, 1993	1155	Current and Closed OB/OD Areas
3	Yes		1	0 - 6"	Yes	1611796.01	2489217.13	UXB, 1993	1156	Current and Closed OB/OD Areas
3	Yes		1	0 - 6"	Yes	1611898.55	2489099.06	UXB, 1993	1157	Current and Closed OB/OD Areas
3	Yes		1	0 - 6"	Yes	1611662.88	2489136.77	UXB, 1993	1158	Current and Closed OB/OD Areas
3	Yes		1	0 - 6"	Yes	1611626.01	2489103.01	UXB, 1993	1159	Current and Closed OB/OD Areas
3	Yes		1	0 - 6"	Yes	1611638.32	2488985.43	UXB, 1993	1160	Current and Closed OB/OD Areas
3	Yes		1	0 - 6"	Yes	1611585.20	2488904.70	UXB, 1993	1161	Current and Closed OB/OD Areas
3	Yes		1	0 - 6"	Yes	1611596.24	2488792.24	UXB, 1993	1162	Current and Closed OB/OD Areas
3	Yes		1	0 - 6"	Yes	1611490.89	2488990.07	UXB, 1993	1163	Current and Closed OB/OD Areas
3	Yes		1	0 - 6"	Yes	1611371.68	2489046.20	UXB, 1993	1164	Current and Closed OB/OD Areas
3	Yes		1	0 - 6"	Yes	1611368.87	2488934.97	UXB, 1993	1165	Current and Closed OB/OD Areas
3	Yes		1	0 - 6"	Yes	1611097.18	2489491.79	UXB, 1993	1166	Current and Closed OB/OD Areas
3	Yes		1	0 - 6"	Yes	1611368.72	2489949.66	UXB, 1993	1167	Current and Closed OB/OD Areas
3	Yes		1	0 - 6"	Yes	1611427.04	2490046.90	UXB, 1993	1168	Current and Closed OB/OD Areas
3	Yes		1	0 - 6"	Yes	1611447.92	2490156.48	UXB, 1993	1169	Current and Closed OB/OD Areas
3	Yes		1	0 - 6"	Yes	1611462.96	2490395.02	UXB, 1993	1170	Current and Closed OB/OD Areas
3	Yes		1	0 - 6"	Yes	1611540.09	2490384.11	UXB, 1993	1171	Current and Closed OB/OD Areas
3	Yes		1	0 - 6"	Yes	1611602.62	2490386.72	UXB, 1993	1172	Current and Closed OB/OD Areas
3	Yes		1	0 - 6"	Yes	1611620.99	2490312.98	UXB, 1993	1173	Current and Closed OB/OD Areas
3	Yes		1	0 - 6"	Yes	1611589.43	2490191.80	UXB, 1993	1174	Current and Closed OB/OD Areas
3	Yes		1	0 - 6"	Yes	1611564.53	2490067.72	UXB, 1993	1175	Current and Closed OB/OD Areas
3	Yes		1	0 - 6"	Yes	1611615.84	2490101.59	UXB, 1993	1176	Current and Closed OB/OD Areas
3	Yes		1	0 - 6"	Yes	1611583.33	2489960.22	UXB, 1993	1177	Current and Closed OB/OD Areas
3	Yes		1	0 - 6"	Yes	1611671.31	2490138.26	UXB, 1993	1178	Current and Closed OB/OD Areas
3	Yes		1	0 - 6"	Yes	1611653.39	2490033.39	UXB, 1993	1179	Current and Closed OB/OD Areas

**Military Munitions Summary Table**  
**Parcel 3**  
**Fort Wingate Depot Activity**  
**Gallup, New Mexico**

Parcel No.	Removed	Item Description	Quantity	Depth (ft. BGS)	Mapped	Northing	Easting	Source	ID No.	Area Description
3	Yes		1	0 - 6"	Yes	1611617.81	2489848.99	UXB, 1993	1180	Current and Closed OB/OD Areas
3	Yes		1	0 - 6"	Yes	1611725.99	2489952.73	UXB, 1993	1181	Current and Closed OB/OD Areas
3	Yes		1	0 - 6"	Yes	1611754.67	2490110.79	UXB, 1993	1182	Current and Closed OB/OD Areas
3	Yes		1	0 - 6"	Yes	1611802.25	2490297.11	UXB, 1993	1183	Current and Closed OB/OD Areas
3	Yes		1	0 - 6"	Yes	1612046.12	2490038.32	UXB, 1993	1184	Current and Closed OB/OD Areas
3	Yes		1	0 - 6"	Yes	1612055.78	2489319.70	UXB, 1993	1185	Current and Closed OB/OD Areas
3	Yes		1	0 - 6"	Yes	1612070.68	2489664.77	UXB, 1993	1186	Current and Closed OB/OD Areas
3	Yes		1	0 - 6"	Yes	1612128.26	2489773.02	UXB, 1993	1187	Current and Closed OB/OD Areas
3	Yes		1	0 - 6"	Yes	1612132.49	2489294.47	UXB, 1993	1188	Current and Closed OB/OD Areas
3	Yes		1	0 - 6"	Yes	1612325.57	2489342.89	UXB, 1993	1189	Current and Closed OB/OD Areas
3	Yes		1	0 - 6"	Yes	1612244.70	2489221.08	UXB, 1993	1190	Current and Closed OB/OD Areas
3	Yes		1	0 - 6"	Yes	1612204.13	2489003.29	UXB, 1993	1191	Current and Closed OB/OD Areas
3	Yes		1	0 - 6"	Yes	1612383.09	2489122.43	UXB, 1993	1192	Current and Closed OB/OD Areas
3	Yes		1	0 - 6"	Yes	1612360.19	2488982.21	UXB, 1993	1193	Current and Closed OB/OD Areas
3	Yes		1	0 - 6"	Yes	1612333.74	2488837.27	UXB, 1993	1194	Current and Closed OB/OD Areas
3	Yes		1	0 - 6"	Yes	1612362.67	2488785.51	UXB, 1993	1195	Current and Closed OB/OD Areas
3	Yes		1	0 - 6"	Yes	1611834.90	2488660.49	UXB, 1993	1196	Current and Closed OB/OD Areas
3	Yes		1	0 - 6"	Yes	1612148.09	2488628.79	UXB, 1993	1197	Current and Closed OB/OD Areas
3	Yes		1	0 - 6"	Yes	1611843.14	2488531.65	UXB, 1993	1198	Current and Closed OB/OD Areas
3	Yes		1	0 - 6"	Yes	1612093.78	2488499.92	UXB, 1993	1199	Current and Closed OB/OD Areas
3	Yes		1	0 - 6"	Yes	1612065.71	2488435.44	UXB, 1993	1200	Current and Closed OB/OD Areas
3	Yes		1	0 - 6"	Yes	1611712.14	2488473.49	UXB, 1993	1201	Current and Closed OB/OD Areas
3	Yes		1	0 - 6"	Yes	1611992.71	2488405.00	UXB, 1993	1202	Current and Closed OB/OD Areas
3	Yes		1	0 - 6"	Yes	1612352.07	2488385.44	UXB, 1993	1203	Current and Closed OB/OD Areas
3	Yes		1	0 - 6"	Yes	1612513.63	2489168.87	UXB, 1993	1204	Current and Closed OB/OD Areas
3	Yes		1	0 - 6"	Yes	1612880.16	2489296.51	UXB, 1993	1205	Current and Closed OB/OD Areas
3	Yes		1	0 - 6"	Yes	1612671.07	2489229.72	UXB, 1993	1206	Current and Closed OB/OD Areas
3	Yes		1	0 - 6"	Yes	1612667.88	2489148.35	UXB, 1993	1207	Current and Closed OB/OD Areas
3	Yes		1	0 - 6"	Yes	1612662.01	2488993.43	UXB, 1993	1208	Current and Closed OB/OD Areas
3	Yes		1	0 - 6"	Yes	1612618.48	2488676.75	UXB, 1993	1209	Current and Closed OB/OD Areas
3	Yes		1	0 - 6"	Yes	1611480.34	2487487.61	UXB, 1993	1210	Current and Closed OB/OD Areas
3	Yes		1	0 - 6"	Yes	1614339.36	2488874.49	UXB, 1993	1211	Current and Closed OB/OD Areas
3	Yes		1	0 - 6"	Yes	1614505.22	2488792.20	UXB, 1993	1212	Current and Closed OB/OD Areas
3	Yes		1	0 - 6"	Yes	1614447.42	2488748.26	UXB, 1993	1213	Current and Closed OB/OD Areas
3	Yes		1	0 - 6"	Yes	1614426.40	2488697.79	UXB, 1993	1214	Current and Closed OB/OD Areas
3	Yes		1	0 - 6"	Yes	1613961.69	2488628.69	UXB, 1993	1215	Current and Closed OB/OD Areas
3	Yes		1	0 - 6"	Yes	1614792.06	2488416.77	UXB, 1993	1216	Current and Closed OB/OD Areas
3	Yes		1	0 - 6"	Yes	1614874.36	2488186.56	UXB, 1993	1217	Current and Closed OB/OD Areas
3	Yes		1	0 - 6"	Yes	1614793.30	2488127.76	UXB, 1993	1218	Current and Closed OB/OD Areas
3	Yes		1	0 - 6"	Yes	1614788.76	2488058.01	UXB, 1993	1219	Current and Closed OB/OD Areas
3	Yes		1	0 - 6"	Yes	1614721.97	2488012.30	UXB, 1993	1220	Current and Closed OB/OD Areas
3	Yes		1	0 - 6"	Yes	1614668.71	2488038.10	UXB, 1993	1221	Current and Closed OB/OD Areas
3	Yes		1	0 - 6"	Yes	1614676.96	2487956.03	UXB, 1993	1222	Current and Closed OB/OD Areas
3	Yes		1	0 - 6"	Yes	1614864.15	2487946.97	UXB, 1993	1223	Current and Closed OB/OD Areas
3	Yes		1	0 - 6"	Yes	1615346.76	2488648.43	UXB, 1993	1224	Current and Closed OB/OD Areas
3	Yes		1	0 - 6"	Yes	1615343.96	2488535.90	UXB, 1993	1225	Current and Closed OB/OD Areas
3	Yes		1	0 - 6"	Yes	1615324.11	2488392.60	UXB, 1993	1226	Current and Closed OB/OD Areas
3	Yes		1	0 - 6"	Yes	1615288.86	2488326.45	UXB, 1993	1227	Current and Closed OB/OD Areas
3	Yes		1	0 - 6"	Yes	1615225.79	2488318.60	UXB, 1993	1228	Current and Closed OB/OD Areas

**Military Munitions Summary Table**  
**Parcel 3**  
**Fort Wingate Depot Activity**  
**Gallup, New Mexico**

Parcel No.	Removed	Item Description	Quantity	Depth (ft. BGS)	Mapped	Northing	Easting	Source	ID No.	Area Description
3	Yes		1	0 - 6"	Yes	1615248.31	2488202.20	UXB, 1993	1229	Current and Closed OB/OD Areas
3	Yes		1	0 - 6"	Yes	1615184.21	2488229.38	UXB, 1993	1230	Current and Closed OB/OD Areas
3	Yes		1	0 - 6"	Yes	1615145.05	2488281.90	UXB, 1993	1231	Current and Closed OB/OD Areas
3	Yes		1	0 - 6"	Yes	1615487.43	2488273.16	UXB, 1993	1232	Current and Closed OB/OD Areas
3	Yes		1	0 - 6"	Yes	1615467.38	2488193.51	UXB, 1993	1233	Current and Closed OB/OD Areas
3	Yes		1	0 - 6"	Yes	1615423.85	2488115.23	UXB, 1993	1234	Current and Closed OB/OD Areas
3	Yes		1	0 - 6"	Yes	1615370.79	2488078.03	UXB, 1993	1235	Current and Closed OB/OD Areas
3	Yes		1	0 - 6"	Yes	1615432.22	2487976.65	UXB, 1993	1236	Current and Closed OB/OD Areas
3	Yes		1	0 - 6"	Yes	1615674.67	2488069.22	UXB, 1993	1237	Current and Closed OB/OD Areas
3	Yes		1	0 - 6"	Yes	1615670.52	2487968.96	UXB, 1993	1238	Current and Closed OB/OD Areas
3	Yes		1	0 - 6"	Yes	1615614.41	2488077.11	UXB, 1993	1239	Current and Closed OB/OD Areas
3	Yes		1	0 - 6"	Yes	1615627.08	2488170.02	UXB, 1993	1240	Current and Closed OB/OD Areas
3	Yes		1	0 - 6"	Yes	1615610.72	2488226.98	UXB, 1993	1241	Current and Closed OB/OD Areas
3	Yes		1	0 - 6"	Yes	1615653.83	2488338.37	UXB, 1993	1242	Current and Closed OB/OD Areas
3	Yes		1	0 - 6"	Yes	1615586.55	2488379.03	UXB, 1993	1243	Current and Closed OB/OD Areas
3	Yes		1	0 - 6"	Yes	1615522.36	2488412.70	UXB, 1993	1244	Current and Closed OB/OD Areas
3	Yes		1	0 - 6"	Yes	1615554.02	2488478.02	UXB, 1993	1245	Current and Closed OB/OD Areas
3	Yes		1	0 - 6"	Yes	1615561.03	2488590.12	UXB, 1993	1246	Current and Closed OB/OD Areas
3	Yes		1	0 - 6"	Yes	1615579.97	2488662.56	UXB, 1993	1247	Current and Closed OB/OD Areas
3	Yes		1	0 - 6"	Yes	1615654.92	2488681.42	UXB, 1993	1248	Current and Closed OB/OD Areas
3	Yes		1	0 - 6"	Yes	1615735.31	2488698.61	UXB, 1993	1249	Current and Closed OB/OD Areas
3	Yes		1	0 - 6"	Yes	1615780.96	2488656.17	UXB, 1993	1250	Current and Closed OB/OD Areas
3	Yes		1	0 - 6"	Yes	1615798.66	2488540.17	UXB, 1993	1251	Current and Closed OB/OD Areas
3	Yes		1	0 - 6"	Yes	1615812.01	2488483.70	UXB, 1993	1252	Current and Closed OB/OD Areas
3	Yes		1	0 - 6"	Yes	1615813.51	2488412.32	UXB, 1993	1253	Current and Closed OB/OD Areas
3	Yes		1	0 - 6"	Yes	1615662.86	2488528.53	UXB, 1993	1254	Current and Closed OB/OD Areas
3	Yes		1	0 - 6"	Yes	1615695.18	2488446.41	UXB, 1993	1255	Current and Closed OB/OD Areas
3	Yes		1	0 - 6"	Yes	1615718.72	2488344.36	UXB, 1993	1256	Current and Closed OB/OD Areas
3	Yes		1	0 - 6"	Yes	1615733.20	2488293.14	UXB, 1993	1257	Current and Closed OB/OD Areas
3	Yes		1	0 - 6"	Yes	1615755.74	2488222.86	UXB, 1993	1258	Current and Closed OB/OD Areas
3	Yes		1	0 - 6"	Yes	1615803.30	2488172.08	UXB, 1993	1259	Current and Closed OB/OD Areas
3	Yes		1	0 - 6"	Yes	1615821.65	2488052.86	UXB, 1993	1260	Current and Closed OB/OD Areas
3	Yes		1	0 - 6"	Yes	1615888.08	2488700.10	UXB, 1993	1261	Current and Closed OB/OD Areas
3	Yes		1	0 - 6"	Yes	1616060.55	2488713.65	UXB, 1993	1262	Current and Closed OB/OD Areas
3	Yes		1	0 - 6"	Yes	1616032.06	2488635.51	UXB, 1993	1263	Current and Closed OB/OD Areas
3	Yes		1	0 - 6"	Yes	1616076.92	2488559.90	UXB, 1993	1264	Current and Closed OB/OD Areas
3	Yes		1	0 - 6"	Yes	1616085.18	2488477.18	UXB, 1993	1265	Current and Closed OB/OD Areas
3	Yes		1	0 - 6"	Yes	1615945.99	2488448.47	UXB, 1993	1266	Current and Closed OB/OD Areas
3	Yes		1	0 - 6"	Yes	1615998.05	2488374.54	UXB, 1993	1267	Current and Closed OB/OD Areas
3	Yes		1	0 - 6"	Yes	1616062.15	2488348.01	UXB, 1993	1268	Current and Closed OB/OD Areas
3	Yes		1	0 - 6"	Yes	1616080.85	2488247.64	UXB, 1993	1269	Current and Closed OB/OD Areas
3	Yes		1	0 - 6"	Yes	1616127.31	2488189.01	UXB, 1993	1270	Current and Closed OB/OD Areas
3	Yes		1	0 - 6"	Yes	1616082.09	2488149.62	UXB, 1993	1271	Current and Closed OB/OD Areas
3	Yes		1	0 - 6"	Yes	1616895.04	2488270.04	UXB, 1993	1272	Current and Closed OB/OD Areas
3	Yes		1	0 - 6"	Yes	1616926.93	2488412.67	UXB, 1993	1273	Current and Closed OB/OD Areas
3	Yes		1	0 - 6"	Yes	1617029.54	2488336.83	UXB, 1993	1274	Current and Closed OB/OD Areas
3	Yes		1	0 - 6"	Yes	1617133.40	2488496.22	UXB, 1993	1275	Current and Closed OB/OD Areas
3	Yes		1	0 - 6"	Yes	1617056.26	2488603.27	UXB, 1993	1276	Current and Closed OB/OD Areas
3	Yes		1	0 - 6"	Yes	1617308.38	2488644.37	UXB, 1993	1277	Current and Closed OB/OD Areas

**Military Munitions Summary Table**  
**Parcel 3**  
**Fort Wingate Depot Activity**  
**Gallup, New Mexico**

Parcel No.	Removed	Item Description	Quantity	Depth (ft. BGS)	Mapped	Northing	Easting	Source	ID No.	Area Description
3	Yes		1	0 - 6"	Yes	1617298.23	2488542.51	UXB, 1993	1278	Current and Closed OB/OD Areas
3	Yes		1	0 - 6"	Yes	1617420.70	2488323.49	UXB, 1993	1279	Current and Closed OB/OD Areas
3	Yes		1	0 - 6"	Yes	1617805.76	2488507.96	UXB, 1993	1280	Current and Closed OB/OD Areas
3	Yes		1	0 - 6"	Yes	1615976.73	2487918.05	UXB, 1993	1281	Current and Closed OB/OD Areas
3	Yes		1	0 - 6"	Yes	1616107.82	2487921.65	UXB, 1993	1282	Current and Closed OB/OD Areas
3	Yes		1	0 - 6"	Yes	1616535.35	2487933.59	UXB, 1993	1283	Current and Closed OB/OD Areas
3	Yes		1	0 - 6"	Yes	1616660.41	2487938.17	UXB, 1993	1284	Current and Closed OB/OD Areas
3	Yes		1	0 - 6"	Yes	1616625.09	2487877.21	UXB, 1993	1285	Current and Closed OB/OD Areas
3	Yes		1	0 - 6"	Yes	1616815.60	2487891.06	UXB, 1993	1286	Current and Closed OB/OD Areas
3	Yes		1	0 - 6"	Yes	1617169.25	2487942.67	UXB, 1993	1287	Current and Closed OB/OD Areas
3	Yes		1	0 - 6"	Yes	1617716.06	2488274.61	UXB, 1993	1288	Current and Closed OB/OD Areas
3	Yes		1	0 - 6"	Yes	1617779.30	2488172.67	UXB, 1993	1289	Current and Closed OB/OD Areas
3	Yes		1	0 - 6"	Yes	1617925.17	2488196.53	UXB, 1993	1290	Current and Closed OB/OD Areas
3	Yes		1	0 - 6"	Yes	1617745.80	2488015.02	UXB, 1993	1291	Current and Closed OB/OD Areas
3	Yes		1	0 - 6"	Yes	1617334.50	2487764.86	UXB, 1993	1292	Current and Closed OB/OD Areas
3	Yes		1	0 - 6"	Yes	1617299.28	2487743.54	UXB, 1993	1293	Current and Closed OB/OD Areas
3	Yes		1	0 - 6"	Yes	1617494.46	2487673.18	UXB, 1993	1294	Current and Closed OB/OD Areas
3	Yes		1	0 - 6"	Yes	1617359.89	2487516.09	UXB, 1993	1295	Current and Closed OB/OD Areas
3	Yes		262	0 - 6"	No			UXB, 1993		Current and Closed OB/OD Areas
3	Yes	20mm Projectile	51	0 - 6"	No			UXB, 1993		Current OB/OD Area
3	Yes	37-40mm Projectile	2495	0 - 6"	No			UXB, 1993		Current OB/OD Area
3	Yes	57mm Projectile	36	0 - 6"	No			UXB, 1993		Current OB/OD Area
3	Yes	60mm Mortar	214	0 - 6"	No			UXB, 1993		Current OB/OD Area
3	Yes	75-76mm Projectile	166	0 - 6"	No			UXB, 1993		Current OB/OD Area
3	Yes	81mm Mortar	40	0 - 6"	No			UXB, 1993		Current OB/OD Area
3	Yes	90mm Projectile	105	0 - 6"	No			UXB, 1993		Current OB/OD Area
3	Yes	105mm Projectile	99	0 - 6"	No			UXB, 1993		Current OB/OD Area
3	Yes	3.5" Rocket Parts	77	0 - 6"	No			UXB, 1993		Current OB/OD Area
3	Yes	M83 Butterfly Bomblets	152	0 - 6"	No			UXB, 1993		Current OB/OD Area
3	Yes	Fuzes - Artillery and Bomb	4282	0 - 6"	No			UXB, 1993		Current OB/OD Area
3	Yes	20LB. Frag Bomb	140	0 - 6"	No			UXB, 1993		Current OB/OD Area
3	Yes	Bulk High Explosive - 49LBS	0	0 - 6"	No			UXB, 1993		Current OB/OD Area
3	Yes	BLU-3 and BLU-4 Bomblets	208	0 - 6"	No			UXB, 1993		Current OB/OD Area
3	Yes	5" Rocket Warheads	10	0 - 6"	No			UXB, 1993		Current OB/OD Area
3	Yes	120mm Projectile	1	0 - 6"	No			UXB, 1993		Current OB/OD Area
3	Yes	Smoke Canister	2	0 - 6"	No			UXB, 1993		Current OB/OD Area
3	Yes	2.75" Rocket Warhead	7	0 - 6"	No			UXB, 1993		Current OB/OD Area
3	Yes	155mm Projectile	1	0 - 6"	No			UXB, 1993		Current OB/OD Area
3	Yes	3" Projectile	1	0 - 6"	No			UXB, 1993		Current OB/OD Area
3	Yes	M2 Bounding Mine	29	0 - 6"	No			UXB, 1993		Current OB/OD Area
3	Yes	20mm Projectile	6	0 - 6"	No			UXB, 1993		Current OB/OD Area
3	Yes	37-40mm Projectile	854	0 - 6"	No			UXB, 1993		Current OB/OD Area
3	Yes	57mm Projectile	9	0 - 6"	No			UXB, 1993		Current OB/OD Area
3	Yes	60mm Mortar	24	0 - 6"	No			UXB, 1993		Current OB/OD Area
3	Yes	75-76mm Projectile	29	0 - 6"	No			UXB, 1993		Current OB/OD Area
3	Yes	81mm Mortar	1	0 - 6"	No			UXB, 1993		Current OB/OD Area
3	Yes	90mm Projectile	8	0 - 6"	No			UXB, 1993		Current OB/OD Area
3	Yes	105mm Projectile	47	0 - 6"	No			UXB, 1993		Current OB/OD Area
3	Yes	3.5" Rocket Parts	7	0 - 6"	No			UXB, 1993		Current OB/OD Area

**Military Munitions Summary Table**  
**Parcel 3**  
**Fort Wingate Depot Activity**  
**Gallup, New Mexico**

Parcel No.	Removed	Item Description	Quantity	Depth (ft. BGS)	Mapped	Northing	Eastings	Source	ID No.	Area Description
3	Yes	M83 Butterfly Bomblets	83	0 - 6"	No			UXB, 1993		Current OB/OD Area
3	Yes	Fuzes - Artillery and Bomb	934	0 - 6"	No			UXB, 1993		Current OB/OD Area
3	Yes	20LB. Frag Bomb	30	0 - 6"	No			UXB, 1993		Current OB/OD Area
3	Yes	Bulk High Explosive - 12LBS	0	0 - 6"	No			UXB, 1993		Current OB/OD Area
3	Yes	BLU-3 and BLU-4 Bomblets	10	0 - 6"	No			UXB, 1993		Current OB/OD Area
3	Yes	5" Rocket Warheads	4	0 - 6"	No			UXB, 1993		Current OB/OD Area
3	Yes	3" Projectile	1	0 - 6"	No			UXB, 1993		Current OB/OD Area
3	Yes	M2 Bounding Mine	59	0 - 6"	No			UXB, 1993		Current OB/OD Area
3	Yes	155mm Projectile	1	0 - 6"	No			UXB, 1993		Current OB/OD Area
3	Yes	20mm Projectile	1	0 - 6"	No			UXB, 1993		Closed OB/OD Area
3	Yes	37-40mm Projectile	135	0 - 6"	No			UXB, 1993		Closed OB/OD Area
3	Yes	57mm Projectile	3	0 - 6"	No			UXB, 1993		Closed OB/OD Area
3	Yes	60mm Mortar	1	0 - 6"	No			UXB, 1993		Closed OB/OD Area
3	Yes	75-76mm Projectile	18	0 - 6"	No			UXB, 1993		Closed OB/OD Area
3	Yes	81mm Mortar	4	0 - 6"	No			UXB, 1993		Closed OB/OD Area
3	Yes	90mm Projectile	11	0 - 6"	No			UXB, 1993		Closed OB/OD Area
3	Yes	105mm Projectile	2	0 - 6"	No			UXB, 1993		Closed OB/OD Area
3	Yes	3.5" Rocket Parts	3	0 - 6"	No			UXB, 1993		Closed OB/OD Area
3	Yes	M83 Butterfly Bomblets	8	0 - 6"	No			UXB, 1993		Closed OB/OD Area
3	Yes	Fuzes - Artillery and Bomb	131	0 - 6"	No			UXB, 1993		Closed OB/OD Area
3	Yes	20LB. Frag Bomb	8	0 - 6"	No			UXB, 1993		Closed OB/OD Area
3	Yes	Bulk High Explosive - 12LBS	0	0 - 6"	No			UXB, 1993		Closed OB/OD Area
3	Yes	BLU-3 and BLU-4 Bomblets	3	0 - 6"	No			UXB, 1993		Closed OB/OD Area
3	Yes	5" Rocket Warheads	1	0 - 6"	No			UXB, 1993		Closed OB/OD Area
3	Yes	M2 Bounding Mine	14	0 - 6"	No			UXB, 1993		Closed OB/OD Area
3	Yes	155mm Projectile	38	0 - 6"	No			UXB, 1993		Closed OB/OD Area
3	Yes	Burster Tube	2	0 - 6"	No			UXB, 1993		Closed OB/OD Area
3	Yes	Tracer	1	0 - 6"	No			UXB, 1993		Closed OB/OD Area
3	Yes	50 cal. API	4	0 - 6"	No			UXB, 1993		Closed OB/OD Area
3	Yes	20mm Projectile	2	0 - 6"	No			UXB, 1993		Closed OB/OD Area
3	Yes	37-40mm Projectile	1094	0 - 6"	No			UXB, 1993		Closed OB/OD Area
3	Yes	60mm Mortar	1	0 - 6"	No			UXB, 1993		Closed OB/OD Area
3	Yes	75-76mm Projectile	32	0 - 6"	No			UXB, 1993		Closed OB/OD Area
3	Yes	81mm Mortar	1	0 - 6"	No			UXB, 1993		Closed OB/OD Area
3	Yes	90mm Projectile	38	0 - 6"	No			UXB, 1993		Closed OB/OD Area
3	Yes	105mm Projectile	2	0 - 6"	No			UXB, 1993		Closed OB/OD Area
3	Yes	3.5" Rocket Parts	2	0 - 6"	No			UXB, 1993		Closed OB/OD Area
3	Yes	M83 Butterfly Bomblets	3	0 - 6"	No			UXB, 1993		Closed OB/OD Area
3	Yes	Fuzes - Artillery and Bomb	3539	0 - 6"	No			UXB, 1993		Closed OB/OD Area
3	Yes	20LB. Frag Bomb	15	0 - 6"	No			UXB, 1993		Closed OB/OD Area
3	Yes	Bulk High Explosive - 47LBS	0	0 - 6"	No			UXB, 1993		Closed OB/OD Area
3	Yes	155mm Projectile	9	0 - 6"	No			UXB, 1993		Closed OB/OD Area
3	Yes	M2 Bounding Mine	12	0 - 6"	No			UXB, 1993		Closed OB/OD Area
3	Yes	Burster Tube	67	0 - 6"	No			UXB, 1993		Closed OB/OD Area
3	Yes	2.75" Rocket Warhead	2	0 - 6"	No			UXB, 1993		Closed OB/OD Area
3	Yes	Fuze Extender	1	0 - 6"	No			UXB, 1993		Closed OB/OD Area
3	Yes	Booster Tube	3	0 - 6"	No			UXB, 1993		Closed OB/OD Area
3	Yes	M2 Bounding Mine Parts	217	0 - 6"	No			UXB, 1993		Closed OB/OD Area
3	Yes	81mm Tail Boom	1	0 - 6"	No			UXB, 1993		Closed OB/OD Area



**Military Munitions Summary Table**  
**Parcel 3**  
**Fort Wingate Depot Activity**  
**Gallup, New Mexico**

Parcel No.	Removed	Item Description	Quantity	Depth (ft. BGS)	Mapped	Northing	Easting	Source	ID No.	Area Description
3	Yes	40mm Red Phosphorus	2	0 - 6"	No			UXB, 1993		Closed OB/OD Area
3	Yes	37mm Shot Canisters	38	0 - 6"	No			UXB, 1993		Closed OB/OD Area
3	Yes	100LB General Purpose Bomb - Partial	2	0 - 6"	No			UXB, 1993		Closed OB/OD Area
3	Yes	Unknown Items	12	0 - 6"	No			UXB, 1993		Closed OB/OD Area
3	Yes	3" Rocket	1	0 - 6"	No			UXB, 1993		Closed OB/OD Area
3	Yes	Smoke Canister/Candle	779	0 - 6"	No			UXB, 1993		Closed OB/OD Area
3	Yes	102mm Mortar	252	0 - 6"	No			UXB, 1993		Closed OB/OD Area
3	Yes	Bulk High Explosive - 5LBS	0	0 - 6"	No			UXB, 1993		Current OB/OD Area
3	Yes	BLU-4 Bomblet	1	0 - 6"	No			UXB, 1993		Current OB/OD Area
3	Yes	Burster Tube	4	0 - 6"	No			UXB, 1993		Current OB/OD Area
3	Yes	BLU-3 Bomblet	1	0 - 6"	No			UXB, 1993		Current OB/OD Area
3	Yes	20mm Projectile	3	0 - 6"	No			UXB, 1993		Current OB/OD Area
3	Yes	37-40mm Projectile	4	0 - 6"	No			UXB, 1993		Current OB/OD Area
3	Yes	75mm Projectile	2	0 - 6"	No			UXB, 1993		Current OB/OD Area
3	Yes	90mm Shell Casing	1	0 - 6"	No			UXB, 1993		Current OB/OD Area
3	Yes	Fuzes - Artillery and Bomb	14	0 - 6"	No			UXB, 1993		Current OB/OD Area
3	Yes	20mm Projectile	1	0 - 6"	No			UXB, 1993		Current OB/OD Area
3	Yes	BLU-3 Bomblet	1	0 - 6"	No			UXB, 1993		Current OB/OD Area
3	Yes	BLU-4 Bomblet	1	0 - 6"	No			UXB, 1993		Current OB/OD Area
3	Yes	M83 Butterfly Bomblets	1	0 - 6"	No			UXB, 1993		Current OB/OD Area
3	Yes	M49 Trip Flare	1	0 - 6"	No			UXB, 1993		Current OB/OD Area
3	No	75mm Projectile	1	Surface	Yes	1610045.34	2491412.26	SWF, 2005	1311	OBOD Kickout Boundary Check
3	No	Scrap	1	Surface	Yes	1612973.55	2494468.18	SWF, 2005	1313	OBOD Kickout Boundary Check
3	No	Scrap	1	Surface	Yes	1612926.64	2494414.18	SWF, 2005	1314	OBOD Kickout Boundary Check
3	No	Scrap	1	Surface	Yes	1612974.34	2494366.88	SWF, 2005	1315	OBOD Kickout Boundary Check
3	No	37 to 40mm Projectile	1	Surface	Yes	1613994.13	2486012.29	SWF, 2005	1321	OBOD Kickout Boundary Check
3	No	Fuze	1	Surface	Yes	1614059.71	2486006.87	SWF, 2005	1322	OBOD Kickout Boundary Check
3	No	Scrap	1	Surface	Yes	1617161.68	2486380.37	SWF, 2005	1326	OBOD Kickout Boundary Check
3	No	Frag	1	Surface	Yes	1622529.01	2487969.31	SWF, 2005	1327	OBOD Kickout Boundary Check
3	No	Fuze	1	Surface	Yes	1617976.82	2487775.03	SWF, 2005	1328	OBOD Kickout Boundary Check
3	No	Fuze	1	Surface	Yes	1617976.79	2487778.03	SWF, 2005	1329	OBOD Kickout Boundary Check
3	No	107mm Projectile	1	Surface	Yes	1617872.97	2487559.75	SWF, 2005	1330	OBOD Kickout Boundary Check
3	No	Burn Pans/Scrap	1	Surface	Yes	1617806.93	2487169.00	SWF, 2005	1331	OBOD Kickout Boundary Check
3	No	155mm Frag and Fuze	1	Surface	Yes	1617342.31	2486554.60	SWF, 2005	1332	OBOD Kickout Boundary Check
3	No	Ordnance	1	Surface	Yes	1617277.90	2486414.08	SWF, 2005	1333	OBOD Kickout Boundary Check
3	No	Ordnance	1	Surface	Yes	1617237.96	2486401.85	SWF, 2005	1334	OBOD Kickout Boundary Check
3	No	Ordnance	1	Surface	Yes	1617095.98	2486403.69	SWF, 2005	1335	OBOD Kickout Boundary Check
3	No	Canister	1	Surface	Yes	1617652.17	2487403.09	SWF, 2005	1336	OBOD Kickout Boundary Check
3	No	Scrap	1	Surface	Yes	1617828.52	2487654.70	SWF, 2005	1337	OBOD Kickout Boundary Check
3	No	Scrap	1	Surface	Yes	1617878.85	2487732.55	SWF, 2005	1338	OBOD Kickout Boundary Check
3	No	105mm Brass \ Burn Rubble	1	Surface	Yes	1617845.97	2487750.17	SWF, 2005	1339	OBOD Kickout Boundary Check
1	No	Scrap	1	Surface	Yes	1610009.27	2490449.56	SWF, 2005	1304	OBOD Kickout Boundary Check
1	No	75mm Projectile	1	Surface	Yes	1609778.36	2490647.38	SWF, 2005	1305	OBOD Kickout Boundary Check
1	No	Scrap	1	Surface	Yes	1609889.17	2491834.12	SWF, 2005	1306	OBOD Kickout Boundary Check
1	No	Scrap	1	Surface	Yes	1609923.77	2492063.81	SWF, 2005	1307	OBOD Kickout Boundary Check
1	No	Scrap	1	Surface	Yes	1609811.02	2492512.84	SWF, 2005	1308	OBOD Kickout Boundary Check
1	No	Scrap	1	Surface	Yes	1609882.42	2493159.99	SWF, 2005	1309	OBOD Kickout Boundary Check
1	No	Scrap	2	Surface	Yes	1609952.24	2492144.50	SWF, 2005	1310	OBOD Kickout Boundary Check
1	No	Scrap - 25 lb piece	1	Surface	Yes	1610002.96	2490786.22	SWF, 2005	1312	OBOD Kickout Boundary Check

**Military Munitions Summary Table**  
**Parcel 3**  
**Fort Wingate Depot Activity**  
**Gallup, New Mexico**

Parcel No.	Removed	Item Description	Quantity	Depth (ft. BGS)	Mapped	Northing	Easting	Source	ID No.	Area Description
1 & 3	Yes	250 lbs. of OE and NON-OE Related Scrap		0 - 4'	Yes			EHSI, 1999		Transect Search Routes
1 & 3	Yes	29 lbs. of OE and NON-OE Related Scrap		0 - 4'	Yes			EHSI, 1999		Grid Survey - Area 16
OFF-SITE	Yes	6,280 lbs. of OE Related Scrap		0 - 12"	Yes			UXB, 1995		UXO Surface Clearance - Off-Site
OFF-SITE	Yes	3.5" rocket motor	1	Surface	Yes	1613973.28	2485511.81	UXB, 1995	1	UXO Surface Clearance - Off-Site
OFF-SITE	Yes	Modified 60mm - M2 mine	1	Surface	Yes	1613772.91	2485479.81	UXB, 1995	2	UXO Surface Clearance - Off-Site
OFF-SITE	Yes	75mm HE projo (no fuze)	1	Surface	Yes	1614332.41	2485509.44	UXB, 1995	3	UXO Surface Clearance - Off-Site
OFF-SITE	Yes	M66A1 tracer	1	Surface	Yes	1613902.26	2485820.15	UXB, 1995	4	UXO Surface Clearance - Off-Site
OFF-SITE	Yes	100 lb mass	1	Surface	Yes	1614650.07	2484826.04	UXB, 1995	5	UXO Surface Clearance - Off-Site
OFF-SITE	Yes	M83	1	Surface	Yes	1614986.49	2485879.06	UXB, 1995	6	UXO Surface Clearance - Off-Site
OFF-SITE	Yes	M83	1	Surface	Yes	1614953.76	2485826.70	UXB, 1995	7	UXO Surface Clearance - Off-Site
OFF-SITE	Yes	40mm projo tracer	1	Surface	Yes	1614842.33	2485868.46	UXB, 1995	8	UXO Surface Clearance - Off-Site
OFF-SITE	Yes	M83	1	Surface	Yes	1614768.71	2485792.81	UXB, 1995	9	UXO Surface Clearance - Off-Site
OFF-SITE	Yes	M66A1 tracer	1	Surface	Yes	1614690.69	2485808.92	UXB, 1995	10	UXO Surface Clearance - Off-Site
OFF-SITE	Yes	75mm HE projo (no fuze)	1	Surface	Yes	1614483.57	2485771.62	UXB, 1995	11	UXO Surface Clearance - Off-Site
OFF-SITE	Yes	M66A1 tracer	1	Surface	Yes	1613291.44	2485850.44	UXB, 1995	12	UXO Surface Clearance - Off-Site
OFF-SITE	Yes	Modified 60mm - M2 mine	1	Surface	Yes	1615247.50	2485802.44	UXB, 1995	13	UXO Surface Clearance - Off-Site
OFF-SITE	Yes	40mm HE projo (no fuze)	1	2"	Yes	1615059.70	2485635.88	UXB, 1995	14	UXO Surface Clearance - Off-Site
OFF-SITE	Yes	M66A1 tracer	1	3"	Yes	1615050.05	2485614.90	UXB, 1995	15	UXO Surface Clearance - Off-Site
OFF-SITE	Yes	M66A1 tracer	1	Surface	Yes	1615894.22	2485775.12	UXB, 1995	16	UXO Surface Clearance - Off-Site
OFF-SITE	Yes	40mm projo tracer (later found inert)	1	Surface	Yes	1615908.29	2485780.40	UXB, 1995	17	UXO Surface Clearance - Off-Site
OFF-SITE	Yes	40mm projo tracer	1	Surface	Yes	1615927.14	2485818.55	UXB, 1995	18	UXO Surface Clearance - Off-Site
OFF-SITE	Yes	40mm HE projo (no fuze)	1	Surface	Yes	1616304.18	2485992.55	UXB, 1995	19	UXO Surface Clearance - Off-Site
OFF-SITE	Yes	M66A1 Full up	1	Surface	Yes	1618201.34	2485948.27	UXB, 1995	20	UXO Surface Clearance - Off-Site
OFF-SITE	Yes	75mm HE projo (no fuze)	1	Surface	Yes	1617217.17	2486043.45	UXB, 1995	21	UXO Surface Clearance - Off-Site
OFF-SITE	Yes	75mm projo (WP)	1	Surface	Yes	1617182.05	2486057.74	UXB, 1995	22	UXO Surface Clearance - Off-Site
OFF-SITE	Yes	37mm projo (no fuze)	1	Surface	Yes	1617058.32	2485916.32	UXB, 1995	23	UXO Surface Clearance - Off-Site
OFF-SITE	Yes	Modified 60mm - M2 mine	1	unknown	Yes	1616285.51	2485295.66	UXB, 1995	24	UXO Surface Clearance - Off-Site
OFF-SITE	Yes	M66A1 tracer	1	unknown	Yes	1616283.61	2485315.48	UXB, 1995	25	UXO Surface Clearance - Off-Site
OFF-SITE	Yes	90mm HE projo (no fuze)	1	Surface	Yes	1617420.86	2485027.46	UXB, 1995	26	UXO Surface Clearance - Off-Site
OFF-SITE	Yes	25 lb frag bomb (no fuze)	1	Surface	Yes	1617358.89	2486008.79	UXB, 1995	27	UXO Surface Clearance - Off-Site
OFF-SITE	Yes	Modified 60mm - M2 mine	1	Surface	Yes	1617354.58	2486064.43	UXB, 1995	28	UXO Surface Clearance - Off-Site
OFF-SITE	Yes	Modified 60mm - M2 mine	1	Surface	Yes	1617222.26	2485816.06	UXB, 1995	29	UXO Surface Clearance - Off-Site
OFF-SITE	Yes	40mm HE projo (no fuze)	1	Surface	Yes	1616235.43	2485543.17	UXB, 1995	30	UXO Surface Clearance - Off-Site
OFF-SITE	Yes	40mm HE projo (no fuze)	1	Surface	Yes	1616235.43	2485543.17	UXB, 1995	31	UXO Surface Clearance - Off-Site
OFF-SITE	Yes	40mm HE projo (no fuze)	1	Surface	Yes	1616235.43	2485543.17	UXB, 1995	32	UXO Surface Clearance - Off-Site
OFF-SITE	Yes	75mm HE projo (no fuze)	1	Surface	Yes	1616294.83	2485477.91	UXB, 1995	33	UXO Surface Clearance - Off-Site
OFF-SITE	Yes	M66A1 tracer	1	Surface	Yes	1616517.51	2485333.84	UXB, 1995	34	UXO Surface Clearance - Off-Site
OFF-SITE	Yes	40mm HE projo (no fuze)	1	Surface	Yes	1616704.98	2485352.30	UXB, 1995	35	UXO Surface Clearance - Off-Site
OFF-SITE	Yes	M66A1 tracer	1	Surface	Yes	1615100.91	2484796.34	UXB, 1995	36	UXO Surface Clearance - Off-Site
OFF-SITE	Yes	75mm HE projo (no fuze)	1	Surface	Yes	1615317.43	2485064.61	UXB, 1995	37	UXO Surface Clearance - Off-Site
OFF-SITE	Yes	75mm HE projo (no fuze)	1	Surface	Yes	1615629.42	2485134.54	UXB, 1995	38	UXO Surface Clearance - Off-Site
OFF-SITE	Yes	40mm projo (no fuze)	1	Surface	Yes	1615040.25	2485018.76	UXB, 1995	39	UXO Surface Clearance - Off-Site
OFF-SITE	Yes	40mm HE projo (no fuze)	1	Surface	Yes	1614908.94	2485169.40	UXB, 1995	40	UXO Surface Clearance - Off-Site
OFF-SITE	Yes	M66A1 tracer	1	Surface	Yes	1614860.24	2485333.11	UXB, 1995	41	UXO Surface Clearance - Off-Site
OFF-SITE	Yes	75mm HE projo (no fuze)	1	Surface	Yes	1615931.60	2485308.23	UXB, 1995	42	UXO Surface Clearance - Off-Site
OFF-SITE	Yes	M66A1 tracer	1	Surface	Yes	1615191.77	2485232.31	UXB, 1995	43	UXO Surface Clearance - Off-Site
OFF-SITE	Yes	M83 Butterfly	1	Surface	Yes	1615095.06	2485207.38	UXB, 1995	44	UXO Surface Clearance - Off-Site
OFF-SITE	Yes	40mm HE projo tracer	1	Surface	Yes	1615370.77	2485748.31	UXB, 1995	45	UXO Surface Clearance - Off-Site
OFF-SITE	Yes	40mm HE projo tracer	1	Surface	Yes	1615307.16	2485810.11	UXB, 1995	46	UXO Surface Clearance - Off-Site

**Military Munitions Summary Table**  
**Parcel 3**  
**Fort Wingate Depot Activity**  
**Gallup, New Mexico**

Parcel No.	Removed	Item Description	Quantity	Depth (ft. BGS)	Mapped	Northing	Easting	Source	ID No.	Area Description
OFF-SITE	Yes	3.5" rocket fuze	1	Surface	Yes	1615566.65	2485912.31	UXB, 1995	47	UXO Surface Clearance - Off-Site
OFF-SITE	Yes	40mm HE projo (no fuze)	1	Surface	Yes	1615679.39	2485887.31	UXB, 1995	48	UXO Surface Clearance - Off-Site
OFF-SITE	Yes	M66A1 tracer	1	Surface	Yes	1615727.77	2485932.12	UXB, 1995	49	UXO Surface Clearance - Off-Site
OFF-SITE	Yes	Mech time fuze (no clock)	1	Surface	Yes	1616248.52	2485979.21	UXB, 1995	50	UXO Surface Clearance - Off-Site
OFF-SITE	Yes	40mm projo tracer	1	Surface	Yes	1616283.19	2485949.87	UXB, 1995	51	UXO Surface Clearance - Off-Site
OFF-SITE	Yes	40mm HE projo (no fuze)	1	Surface	Yes	1615521.46	2485720.28	UXB, 1995	52	UXO Surface Clearance - Off-Site
OFF-SITE	Yes	40mm HE projo (no fuze)	1	Surface	Yes	1615856.51	2485817.73	UXB, 1995	53	UXO Surface Clearance - Off-Site
OFF-SITE	Yes	M83	1	Surface	Yes	1615824.05	2485855.50	UXB, 1995	54	UXO Surface Clearance - Off-Site
OFF-SITE	Yes	40mm HE projo	1	Surface	Yes	1615888.99	2485932.21	UXB, 1995	55	UXO Surface Clearance - Off-Site
OFF-SITE	Yes	40mm HE projo tracer	1	Surface	Yes	1615283.96	2485704.42	UXB, 1995	56	UXO Surface Clearance - Off-Site
OFF-SITE	Yes	40mm projo tracer	1	2"	Yes	1614788.00	2485426.32	UXB, 1995	57	UXO Surface Clearance - Off-Site
OFF-SITE	Yes	M66A1 tracer	1	Surface	Yes	1615173.07	2485384.52	UXB, 1995	58	UXO Surface Clearance - Off-Site
OFF-SITE	Yes	3.5" rocket fuze	1	8"	Yes	1614265.09	2485015.82	UXB, 1995	59	UXO Surface Clearance - Off-Site
OFF-SITE	Yes	M66A1 tracer	1	3"	Yes	1614257.93	2485015.77	UXB, 1995	60	UXO Surface Clearance - Off-Site
OFF-SITE	Yes	M66A1 tracer	1	8"	Yes	1614220.31	2484960.39	UXB, 1995	61	UXO Surface Clearance - Off-Site
OFF-SITE	Yes	M66A1 tracer	1	Surface	Yes	1615686.78	2484810.83	UXB, 1995	62	UXO Surface Clearance - Off-Site
OFF-SITE	Yes	3.5" rocket fuze	1	Surface	Yes	1612237.99	2485517.13	UXB, 1995	63	UXO Surface Clearance - Off-Site
OFF-SITE	Yes	3.5" rocket motor	1	Surface	Yes	1612417.47	2485325.69	UXB, 1995	64	UXO Surface Clearance - Off-Site
OFF-SITE	Yes	75mm (WP)	1	Surface	Yes	1616614.13	2484768.45	UXB, 1995	65	UXO Surface Clearance - Off-Site
OFF-SITE	Yes	Modified 60mm mortar (M2)	1	Surface	Yes	1612558.16	2484930.41	UXB, 1995	66	UXO Surface Clearance - Off-Site
OFF-SITE	Yes	Fuze component	1	2"	Yes	1612399.30	2485151.40	UXB, 1995	67	UXO Surface Clearance - Off-Site
OFF-SITE	Yes	Base fuze/booster? (unknown)	1	Surface	Yes	1614925.40	2484636.40	UXB, 1995	68	UXO Surface Clearance - Off-Site
OFF-SITE	Yes	unknown - partial fuze?	1	unknown	Yes	1616338.16	2485389.46	UXB, 1995	69	UXO Surface Clearance - Off-Site
OFF-SITE	Yes	2 pounds OE scrap (inert)		0 - 1'	Yes	1613859.51	2485952.90	USA, 2001	601	Western Boundary Fence Line - Grid S 21
OFF-SITE	Yes	30 pounds OE scrap (inert)		0 - 1'	Yes	1614044.21	2485958.05	USA, 2001	602	Western Boundary Fence Line - Grid S 22
OFF-SITE	Yes	10 pounds OE scrap (inert)		0 - 1'	Yes	1614236.69	2485958.05	USA, 2001	603	Western Boundary Fence Line - Grid S 23
OFF-SITE	Yes	10 pounds OE scrap (inert)		0 - 1'	Yes	1614421.90	2485961.45	USA, 2001	604	Western Boundary Fence Line - Grid S 24
OFF-SITE	Yes	5 pounds OE scrap (inert)		0 - 1'	Yes	1614619.07	2485964.37	USA, 2001	605	Western Boundary Fence Line - Grid S 25
OFF-SITE	Yes	4 pounds OE scrap (inert)		0 - 1'	Yes	1614812.68	2485969.02	USA, 2001	606	Western Boundary Fence Line - Grid S 26
OFF-SITE	Yes	5 pounds OE scrap (inert)		0 - 1'	Yes	1615016.99	2485969.00	USA, 2001	607	Western Boundary Fence Line - Grid S 27
OFF-SITE	Yes	2 pounds OE scrap (inert)		0 - 1'	Yes	1615210.58	2485986.04	USA, 2001	608	Western Boundary Fence Line - Grid S 28
OFF-SITE	Yes	2 pounds OE scrap (inert)		0 - 1'	Yes	1615402.52	2486003.75	USA, 2001	609	Western Boundary Fence Line - Grid S 29
OFF-SITE	Yes	M83 Butterfly Bomblet (active)		0 - 1'	Yes	1615673.72	2486034.02	USA, 2001	610	Western Boundary Fence Line - Grid S 30
OFF-SITE	Yes	15 pounds OE scrap (inert)		0 - 1'	Yes	1615593.72	2486020.02	USA, 2001	611	Western Boundary Fence Line - Grid S 30
OFF-SITE	Yes	1 pounds OE scrap (inert)		0 - 1'	Yes	1615759.94	2486034.87	USA, 2001	612	Western Boundary Fence Line - Grid S 31
OFF-SITE	Yes	20 pounds OE scrap (inert)		0 - 1'	Yes	1615980.31	2486052.47	USA, 2001	613	Western Boundary Fence Line - Grid S 32
OFF-SITE	Yes	20 pounds OE scrap (inert)		0 - 1'	Yes	1616161.21	2486068.64	USA, 2001	614	Western Boundary Fence Line - Grid S 33
OFF-SITE	Yes	25 pounds OE scrap (inert)		0 - 1'	Yes	1616347.95	2486086.46	USA, 2001	615	Western Boundary Fence Line - Grid N 1
OFF-SITE	Yes	10 pounds OE scrap (inert)		0 - 1'	Yes	1616537.03	2486100.53	USA, 2001	616	Western Boundary Fence Line - Grid N 2
OFF-SITE	No	Frag	1	Surface	Yes	1616520.54	2485912.53	SWF, 2005	1296	UXB Kickout Boundary Check
OFF-SITE	No	Frag	1	Surface	Yes	1616657.99	2485768.40	SWF, 2005	1297	UXB Kickout Boundary Check
OFF-SITE	No	Frag	1	Surface	Yes	1616790.19	2485723.45	SWF, 2005	1298	UXB Kickout Boundary Check
OFF-SITE	No	Scrap	1	Surface	Yes	1617007.92	2485767.77	SWF, 2005	1299	UXB Kickout Boundary Check
OFF-SITE	No	75mm Projectile Frag	1	Surface	Yes	1617423.66	2485749.21	SWF, 2005	1300	UXB Kickout Boundary Check
OFF-SITE	No	Frag	1	Surface	Yes	1617106.02	2485510.17	SWF, 2005	1301	UXB Kickout Boundary Check
OFF-SITE	No	Frag	1	Surface	Yes	1617547.86	2485606.96	SWF, 2005	1302	UXB Kickout Boundary Check
OFF-SITE	No	Fuze and Frag	1	Surface	Yes	1615462.48	2485590.43	SWF, 2005	1303	UXB Kickout Boundary Check
OFF-SITE	No	Frag	1	Surface	Yes	1614606.54	2485904.03	SWF, 2005	1323	OBOD Kickout Boundary Check
OFF-SITE	No	Frag	1	Surface	Yes	1614718.83	2485973.45	SWF, 2005	1324	OBOD Kickout Boundary Check

**Military Munitions Summary Table**  
**Parcel 3**  
**Fort Wingate Depot Activity**  
**Gallup, New Mexico**

Parcel No.	Removed	Item Description	Quantity	Depth (ft. BGS)	Mapped	Northing	Easting	Source	ID No.	Area Description
<b>Sources:</b>										
CMS-OE, 1998. Final Removal Report, OE Sampling and Removal Action, Fort Wingate, Contract DACA87-94-D-0030, DO 0004. CMS Environmental, December 1998.										
CMS-RDAS, 1998. Removal Report, RDAS West Access Road, Fort Wingate, Contract DACA87-94-D-0030, DO 0020. CMS Environmental, March 1998.										
EHSI, 1998. Electrical Contractor Trenching at Administration Area Field Notes. Environmental Hazard Specialists International, November 1998.										
EHSI, 1999. Final OE Location and Removal Report, Fort Wingate Depot Activity, Contract DACA87-97-D-0007, DO 3. Environmental Hazard Specialists International, September 2000.										
SCIE, 1999. Chemical Quality Control Summary Report for the Landfill Closure: Removal and Disposal of Group C and Central Landfills, Contract DACA63-98-C-0065, Scientech, Inc., 1999.										
SEI, 1999. Final Report for Debris Removal in or Near Watercourses, Contract DACA63-99-P-0962, Safe Environment, Inc., 1999.										
SWF, 2001. Final Report, Removal and Disposal of Western Landfill, Contract DACA63-00-D-0011, U.S. Army Corps of Engineers, Fort Worth District, 2001.										
SWF, 2005. Fort Wingate Kickout Boundary Check Field Notes, U.S. Army Corps of Engineers, Fort Worth District, 2005.										
SWF, 2006. Fort Wingate Parcel 3 North Boundary Check Field Notes, U.S. Army Corps of Engineers, Fort Worth District, 2006.										
2002.										
UXB, 1993. Unexploded Ordnance (UXO) Survey Report, Fort Wingate Depot Activity, Contract DAAA15-91-D-0011, DA 05. UXB International, December 1994 and Field Notes. 1995.										